

- English -

Wireless File Transmitter
WFT-E7

Firmware Update Procedures

To comply with various radiowave laws in regions around the world, five types of the WFT-E7 wireless file transmitter (A/B/C/D/E) are being marketed in the target regions. In this document, the product is collectively referred to as “WFT-E7” without distinguishing the types.

Outline of Firmware Update Procedures

1. Format the CF/SD card (64MB or more, 64GB or less) that is to be used for the firmware update.
Use an EOS 5D Mark III camera (hereinafter, camera) for formatting.
2. Copy the firmware update file to the CF/SD card.
Copy the firmware update file (WE700XXX.UPD) downloaded from the Web site to the CF/SD card.
3. Connect the WFT-E7 to the camera.
4. Insert the CF/SD card into the camera.
5. Turn on the power of the camera.
Use a fully-charged, dedicated battery pack or a separately-sold, dedicated AC adaptor kit to power the camera and WFT-E7.
6. From the menu, select “firmware ver.” under “Set-up 4 (Yellow)”, and then press the <SET> button.
7. Update the firmware.
Operate the camera by following the messages that appear on the camera’s LCD monitor.
8. Turn off the power of the camera.
9. Remove the battery pack from the camera.
10. Remove the CF/SD card from the camera.
After updating the firmware, use the camera to format the CF/SD card.

Precautions

- If the power of the camera or WFT-E7 is cut off during the firmware update, the camera may no longer turn on and may no longer be able to shoot.
 - Please use a full-charged, dedicated battery pack and a dedicated AC adaptor to power the camera and WFT-E7.
 - Please be absolutely sure not to turn the power switch on the camera to OFF during the firmware update.
If using a household power source, please be careful about power outages.
- During the firmware update, please do not operate any of the camera's buttons, dials, or switches.
- During the firmware update, please do not open the card slot cover.
- The illustrations for the EOS 5D Mark III are used in this document.

Firmware Update Procedures

- In the explanations below, X.X.X. indicates the current firmware version or the new firmware version after the update.

(1) Format the CF/SD card.

Check carefully whether there are any important files left on the CF/SD card.

After having checked the content of the CF/SD card carefully, format the CF/SD card that is to be used for the firmware update.

Insert the CF/SD card into the camera, and then turn the power switch of the camera to ON. Press the <MENU> button, and select [Format] under “Set-up 1 (Yellow)” to format the CF/SD card.

*For firmware updates, use an empty CF/SD card that has been formatted using the camera.

(2) Copy the firmware update file to the CF/SD card.

Copy the firmware update file to the root directory of the CF/SD card. The name of the firmware update file is “WE700XXX.UPD”. (“XXX” indicates the firmware version.)

(3) Connect the WFT-E7 to the camera.

(4) Insert the CF/SD card prepared in step 2 into the camera.

(5) Turn on the power of the camera.

Use a fully-charged, dedicated battery pack or a separately-sold, dedicated AC adaptor kit to power the camera and WFT-E7.

(6) From the menu, select “firmware ver.” under “Set-up 4 (Yellow)”, and then press the <SET> button.

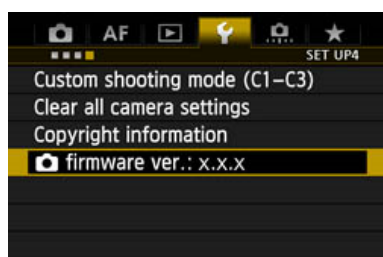

(7) Update the firmware.

Operate the camera by following the messages that appear on the camera's LCD monitor.

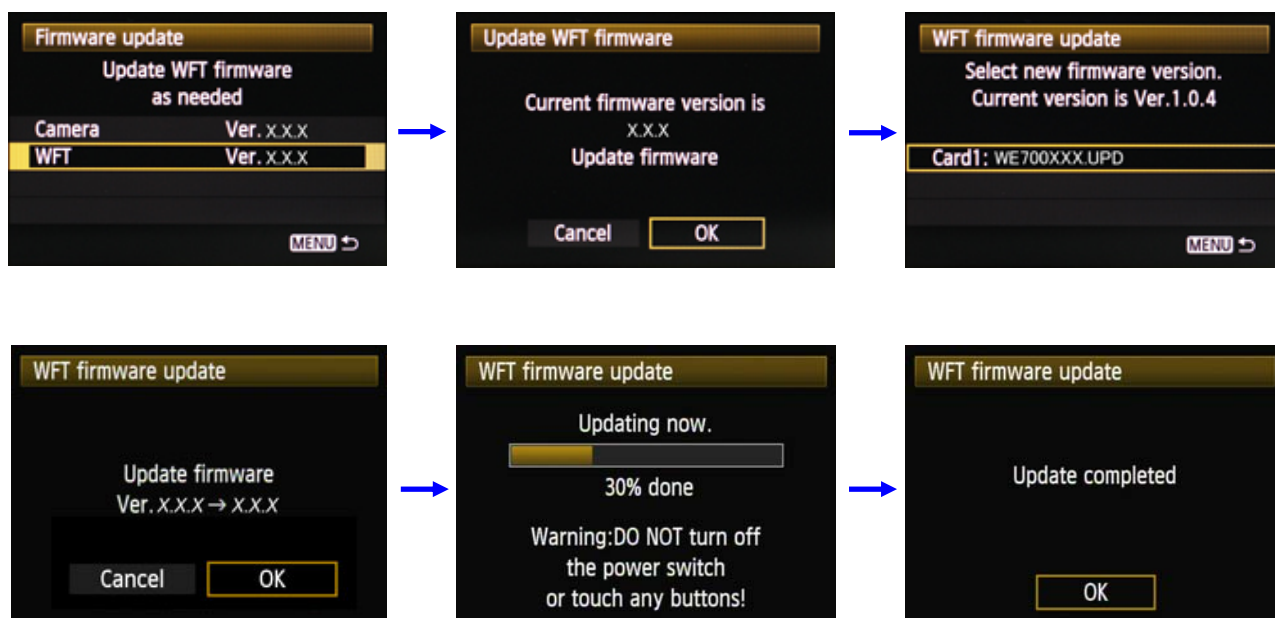

(8) Turn off the power of the camera.

(9) Remove the battery pack from the camera.

(10) Remove the CF/SD card from the camera.

After updating the firmware, use the camera to format the CF/SD card.

If an ERROR message appears during the firmware update

During the firmware update, if the error screen appears, remove the battery pack and check to make sure whether there are any problems with the battery capacity or the firmware update file on the CF/SD card.

If there are no problems, repeat the update operations again.

If the problem persists, please contact our service centers.