

PowerShot A560 SYSTEM MAP

DIGITAL CAMERA

Canon

Supplied with Camera

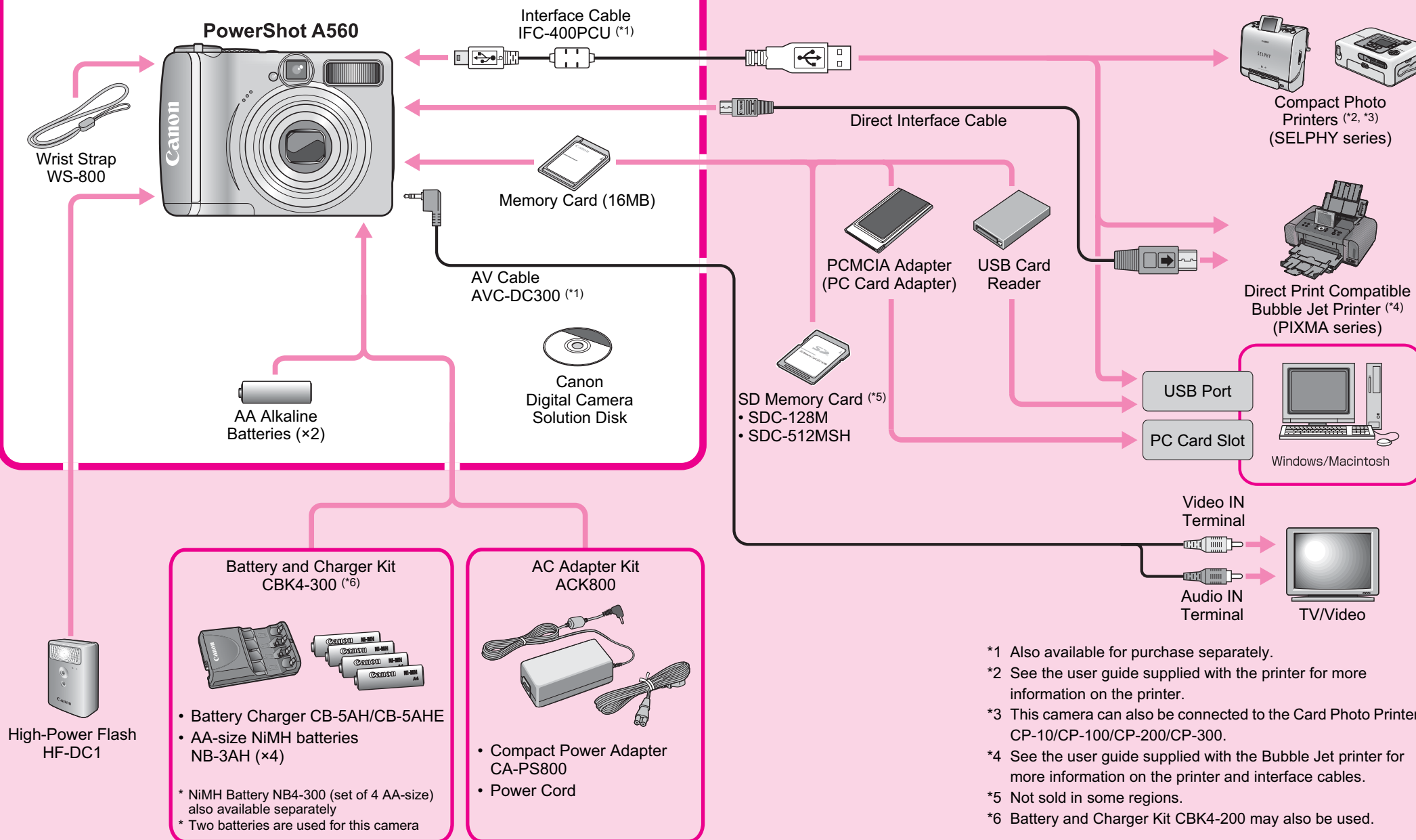

*1 Also available for purchase separately.

*2 See the user guide supplied with the printer for more information on the printer.

*3 This camera can also be connected to the Card Photo Printer CP-10/CP-100/CP-200/CP-300.

*4 See the user guide supplied with the Bubble Jet printer for more information on the printer and interface cables.

*5 Not sold in some regions.

*6 Battery and Charger Kit CBK4-200 may also be used.

Confirming the Package Contents

Your camera package includes all of the following items. If any of these items are missing, please contact the dealer for assistance.

- Digital Camera
- Wrist Strap WS-800
- AA Alkaline Batteries (×2)
- Memory Card (16MB)
- Interface Cable IFC-400PCU
- AV Cable AVC-DC300
- Canon Digital Camera Solution Disk
- Basic Camera User Guide
- Advanced Camera User Guide
- Direct Print User Guide
- Software Starter Guide
- System Map (this sheet)
- Warranty Card
- “Canon Customer Support” Leaflet

Optional Accessories

The following camera accessories are sold separately. **Some accessories are not sold in some regions.**

Flash

- **High-Power Flash HF-DC1**
This attachable supplementary flash can be used to capture photographic subjects that are too distant for the built-in flash to illuminate.

Power Supplies

- **AC Adapter Kit ACK800**
This kit lets you power the camera from any standard household power outlet. Recommended to power a camera for an extended period of time or when connecting to a computer.
- **Battery and Charger Kit CBK4-300**
This dedicated battery charger kit includes both a charger unit and four rechargeable AA-size NiMH (nickel metal hydride) batteries. Convenient when taking or playing back large numbers of images.
- **NiMH Battery NB4-300**
A set of four rechargeable AA-size NiMH batteries. Two batteries are used for this camera.

Other Accessories

- **SD Memory Card**
SD memory cards are used to store images recorded by the camera. Canon brand cards are available in 128 MB and 512 MB capacities.
- **Interface Cable IFC-400PCU**
Use this cable to connect the camera to a computer, Compact Photo Printer (SELPHY series) or to a Bubble Jet printer (refer to your Bubble Jet printer user guide).
- **AV Cable AVC-DC300**
Use this cable to connect the camera to a TV set.

Direct Print Compatible Printers

Canon offers the following separately sold printers for use with the camera. You can produce photo quality prints quickly and easily by connecting them to the camera with a single cable and operating the camera's controls.

- **Compact Photo Printers (SELPHY series)**
- **Bubble Jet Printers (PIXMA series)**

For more information, visit your nearest Canon retailer.