

Speedlite
220EX



Speedlite
430EX



Speedlite
580EX

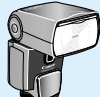

High-Power Flash
HF-DC1



Conversion Lens Adapter
LA-DC58H

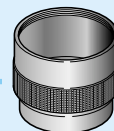

Wide Converter
WC-DC58B

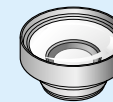

Tele-converter
TC-DC58C



Supplied with Camera

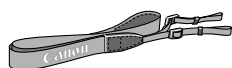

Neck Strap
NS-DC5



Battery Pack
NB-2LH^{*1*6}



Terminal Cover



Battery Charger
CB-2LW/CB-2LWE^{*1*7}



Interface Cable IFC-400PCU^{*1}



Memory Card
(32MB)

AV Cable
AVC-DC300^{*1}



Canon Digital Camera
Solution Disk

Soft Case^{*5}
SC-DC50

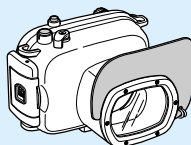

Waterproof Case
WP-DC11



Car Battery Charger
CBC-NB2

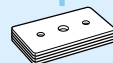

Waterproof Case
Weight WW-DC1

AC Adapter Kit ACK-DC20

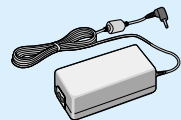

Compact Power Adapter
CA-PS700

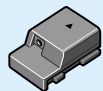

DC Coupler
DR-20

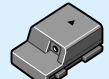

DC Coupler^{*2}
DR-700



Power Cord



Compact Photo Printer^{*4}
(SELPHY CP series)

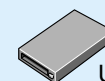

USB Card
Reader



PCMCIA Adapter

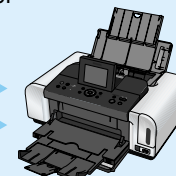

Direct Print Compatible
Bubble Jet Printer (PIXMA
series/SELPHY DS series)

Direct Interface
Cable^{*3}



SD Memory Card^{*5}
• SDC-128M
• SDC-512MSH

USB Port

PC Card
Slot

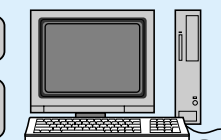

Windows/Macintosh

Video IN Terminal

Audio IN Terminal



TV/Video

^{*1} Also available for purchase separately.

^{*2} Cannot be used with the PowerShot G7.

^{*3} See the user guide supplied with the Bubble Jet printer for more information on the printer and interface cables.

^{*4} This camera can also be connected to the Card Photo Printer CP-10/CP-100/CP-200/CP-300.

^{*5} Not sold in some regions.

^{*6} Battery Pack NB-2L may also be used.

^{*7} Battery Charger CB-2LT/CB-2LTE may also be used.

Confirming the Package Contents

Your camera package includes all of the following items. If any of these items are missing, please contact the dealer for assistance.

- Digital Camera
- Neck Strap NS-DC5
- Battery Pack NB-2LH
- Battery Pack Terminal Cover
- Battery Charger CB-2LW/CB-2LWE
- Memory Card (32MB)
- Interface Cable IFC-400PCU
- AV Cable AVC-DC300
- Canon Digital Camera Solution Disk
- Basic Camera User Guide
- Advanced Camera User Guide
- Direct Print User Guide
- Software Starter Guide
- System Map (this sheet)
- Warranty Card
- “For Windows® XP and Mac OS X Users” Leaflet
- “Canon Customer Support” Leaflet

Optional Accessories

The following camera accessories are sold separately. **Some accessories are not sold in some regions.**

Lenses, Lens Adapter

- **Conversion Lens Adapter LA-DC58H**
This adapter is required for mounting the wide converter, tele-converter and close-up lens to the camera.
- **Wide Converter WC-DC58B**
Converts the focal distance of the body lens by a factor of approximately 0.75 when attached.
- **Tele-converter TC-DC58C**
Converts the focal distance of the body lens by a factor of approximately 2 when attached.

Flash

- **EX-Series Speedlites**
Speedlites for Canon EOS models. Subjects are optimally illuminated for crisp, natural images.
 - **Speedlite 220EX/430EX/580EX**
- **High-Power Flash HF-DC1**
This attachable supplementary flash can be used to capture the photographic subjects that are too distant for the built-in flash to illuminate.

Power Supplies

- **AC Adapter Kit ACK-DC20**
 - **Compact Power Adapter CA-PS700**
This is an adapter to supply power from household power outlets.
 - **DC Coupler DR-20**
 - **DC Coupler DR-700**
(Cannot be used with the PowerShot G7)
 - **Power Cord**
- **Battery Charger CB-2LW/CB-2LWE**
A battery charger for Battery Pack NB-2LH.
- **Battery Pack NB-2LH**
Rechargeable lithium ion battery.
- **Car Battery Charger CBC-NB2**
Allows you to change your camera's battery from the cigarette lighter socket of your car.

Other Accessories

- **SD Memory Card**
SD memory cards are used to store images recorded by the camera. Canon brand cards are available in 128 MB and 512 MB capacities.
- **Interface Cable IFC-400PCU**
Use this cable to connect the camera to a computer, Compact Photo Printer (SELPHY series) or to a Bubble Jet printer (refer to your Bubble Jet printer user guide).
- **AV Cable AVC-DC300**
Use this cable to connect the camera to a TV set.
- **Waterproof Case WP-DC11**
You can use this case to take underwater shots at depths of up to 40 meters (130 feet), and of course it's ideal for taking worry-free pictures in the rain, at the beach, or on the ski slopes.
- **Soft Case SC-DC50**
Protects the camera from scratching and dust.

Direct Print Compatible Printers

Canon offers the following separately sold printers for use with the camera. You can produce photo quality prints quickly and easily by connecting them to the camera with a single cable and operating the camera's controls.

- **Compact Photo Printers (SELPHY ES series/SELPHY CP series)**
- **Bubble Jet Printers**

For more information, visit your nearest Canon retailer.