

Canon

PIXMA iP6000D

Photo Printer

Direct Printing Guide

Contents

Operation Panel and Menu Display

Operation Panel Names and Functions	3
Menu Displays	5

Printing Flow

Using a Memory Card

Memory Cards Supported by This Printer	10
Inserting a Memory Card	11
Removing a Memory Card	13

Loading Paper

Printing Photograph

Printing a Photo Displayed on the LCD - Photo Gallery	22
Specifying How Many Copies to Print for Each Photo - Photo Print	25
Changing the Print Settings	27

Other Useful Functions

Searching for Photos with the Shooting Date	30
Printing a Specified Area – Trimming	32
Specifying the Layout	34
Printing on the Sticker – Sticker Print	37
Printing in Your Favorite Color Tone – Color Balance	40
Printing All Photos	43
Printing a Photo List – Print Index	44
Printing According to the Settings Made on the Camera – DPOF Printing	45

Changing Other Settings

Adjusting Contrast of the LCD	47
Reducing the Sound of Printer Operation	48
Setting the Date Display Format	49
Resetting All the Settings	50
Changing the Language Displayed	51

Printing Photographs Directly from a Digital Camera

Connecting to a Digital Camera	52
Direct Printing from PictBridge-compatible Digital Cameras	54
Printing Photographs Directly from a Canon Bubble Jet Direct Compatible Digital Camera	57

Printing Photos in the Mobile Phone through Infrared Communication

– Printbeam

Requirements for Infrared Communication	58
Setting the Media Type, Paper Size, and Layout When Printing From a Mobile Phone	58
Performing Infrared Communication	60

Using Data in the Memory Card on the Computer

Browsing Photos in the Memory Card on the Computer	62
Saving Data in the Memory Card onto the Computer	63
Setting up the Card Slot as the Memory Card Drive of the Computer	64

Replacing an Ink Tank

Knowing When to Replace Ink Tank	66
Replacing Ink Tanks	67

Printing Maintenance

When Printing Becomes Faint or Colors are Incorrect	70
Printing the Nozzle Check Pattern	71
Examining the Nozzle Check Pattern	72
Print Head Cleaning	73
Print Head Deep Cleaning	74
Aligning Print Head - Auto head align	75

Troubleshooting

A Message is Displayed on the LCD	77
-----------------------------------------	----

Index	86
--------------------	----

Operation Panel and Menu Display

The names and functions of the controls on the operation panel, how to display the menus, and the items in the menus are described below:

Operation Panel Names and Functions

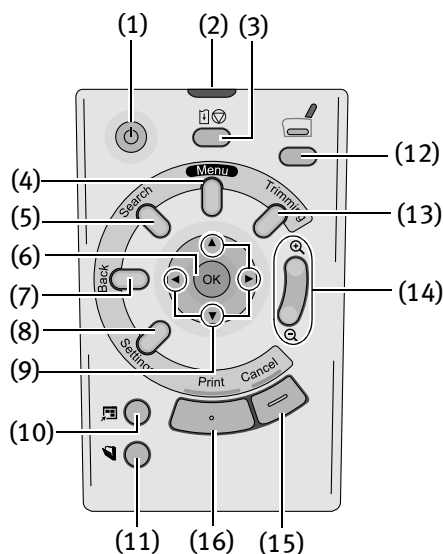

(1) POWER Button

Press to turn the printer on or off.

(2) POWER Lamp

Off:
the printer is turned off.

Green:
the printer is ready to print.

Flashing green:
the printer is preparing to print, or is currently
printing.

Flashing orange:
an error has occurred and the printer is not ready to
print.

Flashing orange and green alternately:
an error has occurred that may require a service
call.

(3) RESUME Button

Press to resume printing after resolving a printer
problem.

(4) Menu Button

Displays menus. See “Menu Displays” on page 5.

(5) Search Button

Looks up target photos in the memory card using the shooting date as the search key. See
“Searching for Photos with the Shooting Date” on page 30.

(6) OK Button

Allows you to make a selection. For example, selecting a photo to be printed, selecting a
menu item or other setting.

(7) Back Button

Allows you to return to the previous screen.

(8) Settings Button

Allows you to set the Paper Size, Paper Type, Bordered/Borderless printing, printing with the
date, etc. See “Changing the Print Settings” on page 27.

(9) ▲ ▼ ◀ ▶ Buttons

Use these buttons, shown as arrows on the LCD, to select a menu item or photo, to specify the number of copies to print, to make print settings, or to scroll the screen.

(10) Easy-PhotoPrint Startup Button

Starts Easy-PhotoPrint. See “Browsing Photos in the Memory Card on the Computer” on page 62.

(11) Save Button

Saves data in the memory card onto the computer’s hard disk. See “Saving Data in the Memory Card onto the Computer” on page 63.

(12) Paper Feed Switch

Selects the paper source. Press this toggle switch to change the paper source between the sheet feeder and cassette.

(13) Trimming Button

Allows you to trim the photo being displayed on the screen. See “Printing a Specified Area – Trimming” on page 32.

(14) ⌕ 🔍 Buttons

Press to enlarge or reduce the photo being displayed. Pressing this button in trimming mode allows you to enlarge/reduce the area to be trimmed. See “Trimming and Rotating the Sections you wish to Print.” on page 32.

(15) Cancel Button

Press to cancel the settings you have made. If this button is pressed during printing, the printer aborts printing.

(16) Print Button

Press to start printing according to the settings displayed on the LCD.

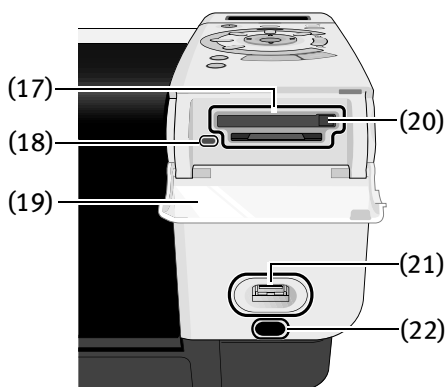

(17)Card Slot

Set the memory card containing photos here.

(18)Indicator Lamp

The indicator lamp is lit when memory card reading is enable and flashes while the memory card is being read.

(19)Card Slot Cover

Close this after inserting a memory card.

(20)Card Eject Button

Press to remove CompactFlash (CF) card or Micro Drive. See “Removing a Memory Card” on page 13.

(21)Direct Print Port

Connects the printer to a compatible digital camera or digital video camcorder. See “Connecting to a Digital Camera” on page 52.

(22)IrDA Interface Port

Connects the printer to a computer through a wireless IrDA connection.

Menu Displays

When pressing the Menu button, the Menu screen appears. You can print photos with various options as well as maintain the printer using items on the Menus.



Photo Gallery

You can view the photos in the memory card on the LCD and print them. See “Printing a Photo Displayed on the LCD - Photo Gallery” on page 22.

Photo Print

You can specify how many copies to print for each photo and print them at once. See “Specifying How Many Copies to Print for Each Photo - Photo Print” on page 25.

Print Studio

Provides useful print options below.



Layout print

Prints photos in various layouts such as tiling, album, postcard, etc. See “Specifying the Layout” on page 34.

**Sticker print**

Prints photos on the Canon-branded sticker. See “Printing on the Sticker – Sticker Print” on page 37.

**Color balance**

Prints 9 color samples of a photo on a sheet of paper. You can select your favorite color tone from them and print. See “Printing in Your Favorite Color Tone – Color Balance” on page 40.

**Print all**

Prints all photos in a memory card. See “Printing All Photos” on page 43.

**Print index**

Prints an index of all photos in the memory card. See “Printing a Photo List – Print Index” on page 44.

**DPOF print**

Prints photos according to the DPOF settings set on the digital camera. See “Printing According to the Settings Made on the Camera – DPOF Printing” on page 45.

**Tool Box**

Displays the setting items below.

Nozzle check

Prints a check pattern to ensure that ink is output correctly, or that the print head is aligned properly. See “Printing the Nozzle Check Pattern” on page 71.

Contrast

Adjusts the contrast of the LCD. See “Adjusting Contrast of the LCD” on page 47.

Head cleaning

Cleans the print head when nozzles are clogged. See “Print Head Cleaning” on page 73.

Quiet mode

Reduces the printing noise. See “Reducing the Sound of Printer Operation” on page 48.

Deep cleaning

If print quality does not improve after standard head cleaning, use deep cleaning. See “Print Head Deep Cleaning” on page 74.

Date display format

Changes the format of date printing. See “Setting the Date Display Format” on page 49.

Auto head align

Aligns the print head automatically. See “Aligning Print Head - Auto head align” on page 75.

Manual head align

Aligns the print head manually. See “Adjusting the Print Head Manually” on page 78.

Head alignment print

Prints the current settings of the print head position. See “Aligning Print Head - Auto head align” on page 75.

Thick paper

Use the **Thick Paper** setting if white streaks appear on the printed page or the printed surface is scratched. See “If the printed surface is still scratched:” on page 80.

Infrared print

Sets the paper size and layout of the print via infrared communication from the mobile phone. See “Printing Photos in the Mobile Phone through Infrared Communication – Printbeam” on page 58.

Reset

Resets all settings other than the display language and the print head position to the initial state. See “Resetting All the Settings” on page 50.

Languages

Sets the Language displayed on the LCD. See “Changing the Language Displayed” on page 51.

Printing Flow

This is the procedure for printing photos from the memory card inserted in the card slot of the printer.

Step 1 Turn on the Printer.

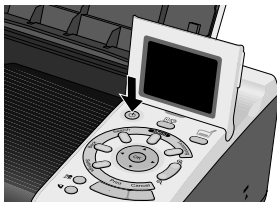

Step 2 Load the paper.

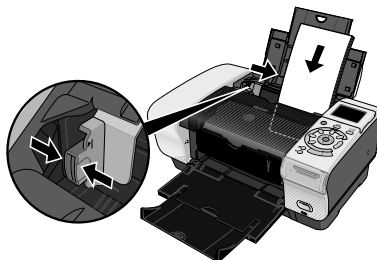

See “Loading Paper” on page 15.

Step 3 Ensure the paper source.

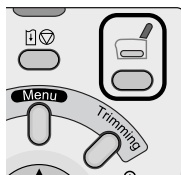

See page 22.

Step 4 Insert the memory card.



See “Using a Memory Card” on page 10.

Step 5 Select a Menu.

Press the ◀ ▶ buttons to select a printing menu.

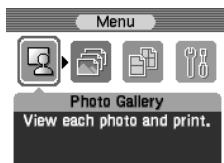
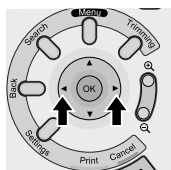

Step 6 Select photos to print.

Select photos to print using the ◀ ▶ buttons.

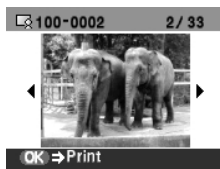
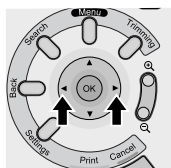

Step 7 Check print setting.

The setting confirmation screen appears when pressing the OK button.

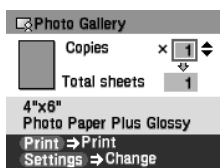
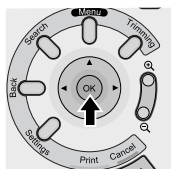

Press the Settings button to change the print settings.

See "Changing the Print Settings" on page 27.

Step 8 Start printing.

Press the Print button to start printing.

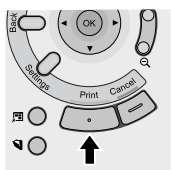

Using a Memory Card

Let's take a look at different types of memory cards and how to insert and remove them.

Memory Cards Supported by This Printer

Supported memory cards are as follows:

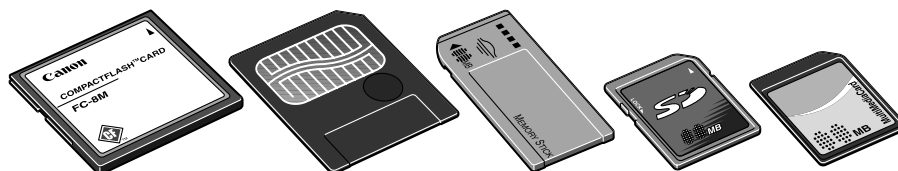

- CompactFlash™ (CF) Card/Microdrive™
* Supports TYPE I/TYPE II (3.3V).
- SmartMedia™ Card
* Supports 3.3V card only (1MB and 2MB cards not supported)
- Memory Stick®
- Secure Digital™ (SD) Card
- MultiMedia™ Card

Other memory cards can be used through the adapter which is compatible with the above.

- Important**
- Photos stored in a memory card not supported by the digital camera may fail in loading or be damaged. For types of memory cards supported by the digital camera, refer to your digital camera user's manual.
 - To format a memory card, use the digital camera. Memory card data formats may not be compatible with computer-specific formats.
 - Photos edited on the computer may result in improper printing.
 - Please use only one type of memory card at a time. If you use more than 2 types of memory card at the same time, you could lose data or data could be read incorrectly from the cards.

Inserting a Memory Card

-  **Notes**
- When **Read/write mode** is selected in the Memory Card Utility, neither printing nor maintenance can be done. After using the card slot as the memory card drive of the computer, be sure to select **Read-only mode** again. See “Setting up the Card Slot as the Memory Card Drive of the Computer” on page 64.
 - If you used a computer to edit or process the data stored in the memory card, be sure to print photos from the computer. Using the operation panel to print photos may result in improper printing.

- 1** Turn on the printer.
- 2** Open the card slot cover.

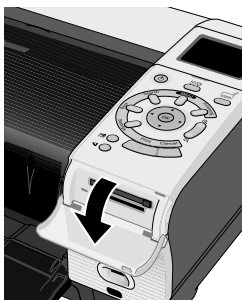

- 3** Install the memory card in the card slot.

The Indicator lamp lights.

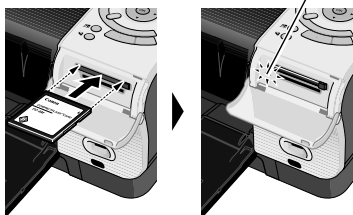

- If you use a CompactFlash (CF) card or Microdrive, insert it as far as it will go as shown left.

The Indicator lamp lights.

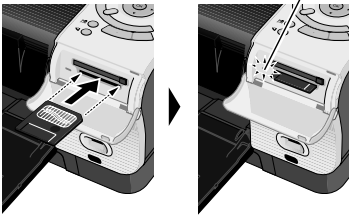

- If you use a SmartMedia card, insert it until it stops with its end projecting as shown left.

The Indicator lamp lights.

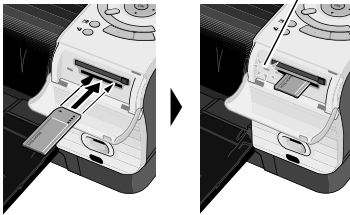

- If you use a Memory Stick, SD card or MultiMedia card, insert it until it stops with its end projecting as shown left.

Removing a Memory Card

-  **Note** ● If you use the printer connected to your computer, follow the instructions for removal of the memory card from the computer. For the procedure, refer to the on-screen *User's Guide*.

1 Ensure that the Indicator lamp is not flashing, then remove the memory card.

- Important** ● Removing the memory card or turning off the printer while the Indicator lamp is flashing can damage the data stored in the memory card.

Card eject button

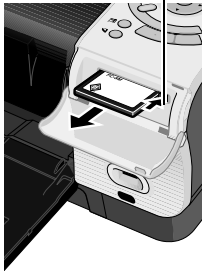

- If you use CompactFlash (CF) card or Microdrive, press the card eject button to remove the card.

Indicator lamp

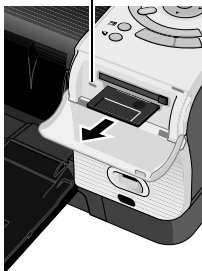

- If you use a SmartMedia card, hold the exposed portion of the memory card with your fingers to remove the memory card.

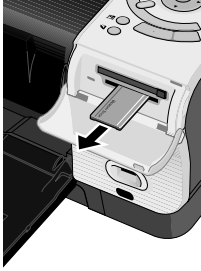

- If you use a Memory Stick, SD card or MultiMedia card, hold the exposed portion of the memory card with your fingers to remove the memory card.

2 Close the Card Slot Cover.

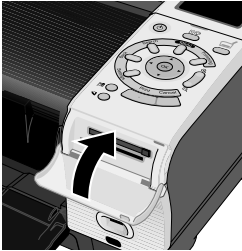

Loading Paper

This section describes how to load the paper and select the paper sizes and types from the operation panel.

■ Print Media to Avoid

Do not use the following types of paper. Using such paper will not only produce unsatisfactory results, but can also cause the printer to jam or malfunction.

- Folded, curled or wrinkled paper
- Damp paper
- Excessively thin paper (less than 64 gsm or 17 lb)
- Excessively thick paper* (more than 105 gsm or 28 lb)
*non-Canon branded paper
- Picture postcards
- Postcards affixed with photos or stickers
- Any type of paper with holes (Loose-leaf paper is an exception; it is printable when loaded from the sheet feeder.)

■ About the Sheet Feeder and the Cassette

You can use both the sheet feeder and the cassette to feed paper.

Loading paper in the sheet feeder is easy, and is convenient if you frequently switch to and print on various sizes or types of paper.

Loading paper in the cassette allows you to print without reloading paper for each job. This is convenient for loading a large volume of the type of paper you regularly print onto.

Loading paper in both the sheet feeder and cassette makes the following paper feed methods available:

- **Changing the paper source to feed different types/sizes of paper**
If you load plain paper in the cassette and photo paper in the sheet feeder, changing the paper source allows you to print on both types of paper without removing and reloading paper. To change the paper source, use the paper feed switch on the printer.
- **Choosing the paper source to match the location of the printer**
You can use just the sheet feeder or cassette according to the location of the printer. For example, if you intend to install the printer in a small place, such as on a shelf with minimal space, you can use just the cassette for printing.

Caution You cannot load sticker paper in the cassette. Load one sheet at a time in the sheet feeder.

 **Note** Depending on the size of paper you use or during printer maintenance, you may have to use the sheet feeder. When using only the cassette, check that the printer can perform the operations you require.

■ Loading the Print Media in the Sheet Feeder

In this example, description is provided using Photo Paper Plus Glossy 4" x 6" in your printer.

- Refer to “Media Types for Card Direct Printing” on page 21 for compatible paper.

1 Flatten the four corners of the paper before loading it.

 **Note** If paper is curled, gently bend the corners in the opposite direction until the paper becomes completely flat. Refer to “Uncurling the Media” on the *User's Guide*.

2 Preparing to Load Paper.

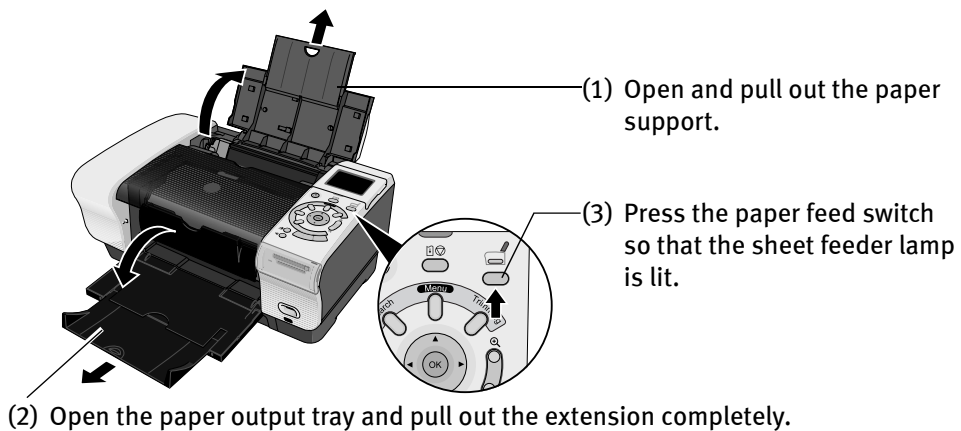

3 Loading the Paper

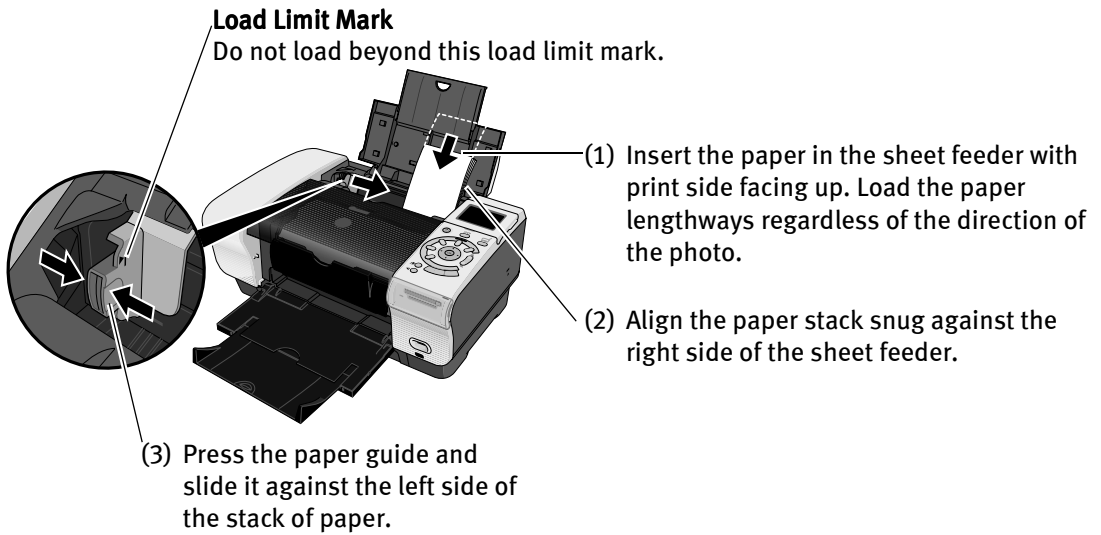

Note

Do not touch the printed surface until the ink dries. For specific drying times, refer to the instructions packaged with your media.

■ Loading the Print Media in the Cassette

In this example, description is provided using Photo Paper Plus Glossy 4" x 6" in your printer.

- Refer to “Media Types for Card Direct Printing” on page 21 for compatible paper.

Caution You cannot load sticker paper in the cassette. Load one sheet at a time in the sheet feeder.

1 Flatten the four corners of the paper before loading it.

 **Note** If paper is curled, gently bend the corners in the opposite direction until the paper becomes completely flat.

2 Preparing to Load Paper.

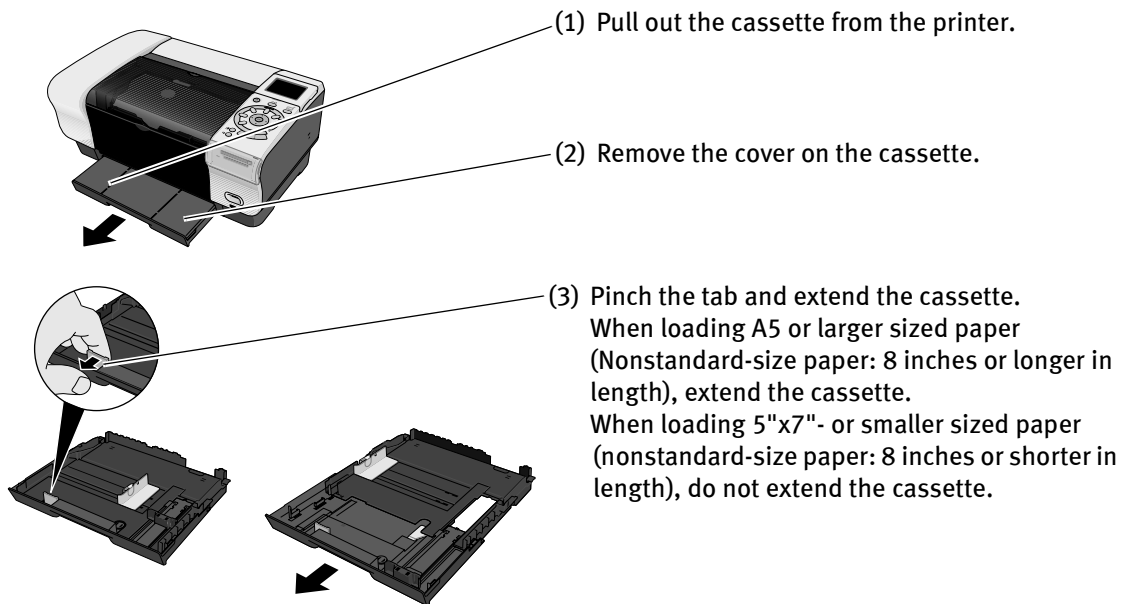

 **Note** Legal-sized paper is not loadable in the cassette.

3 Loading the Paper.

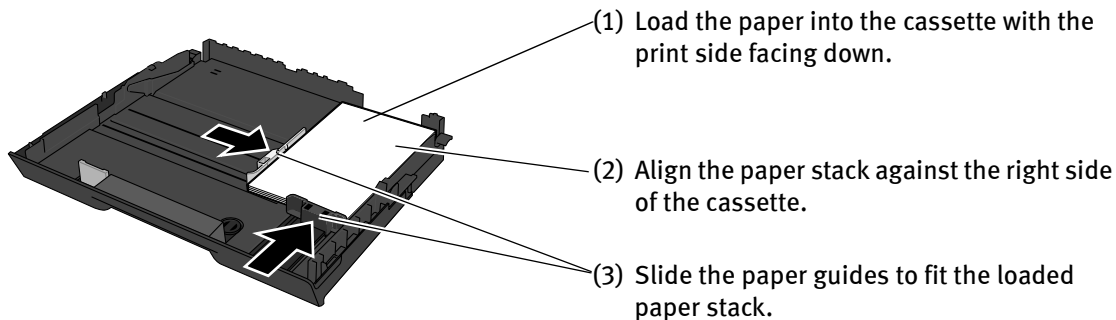

4 Insert the cassette into the printer.

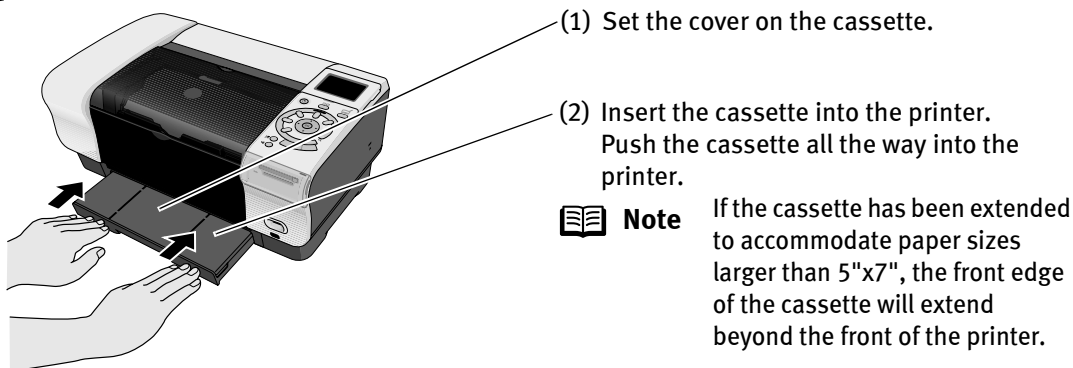

5 Prepare the paper output tray.

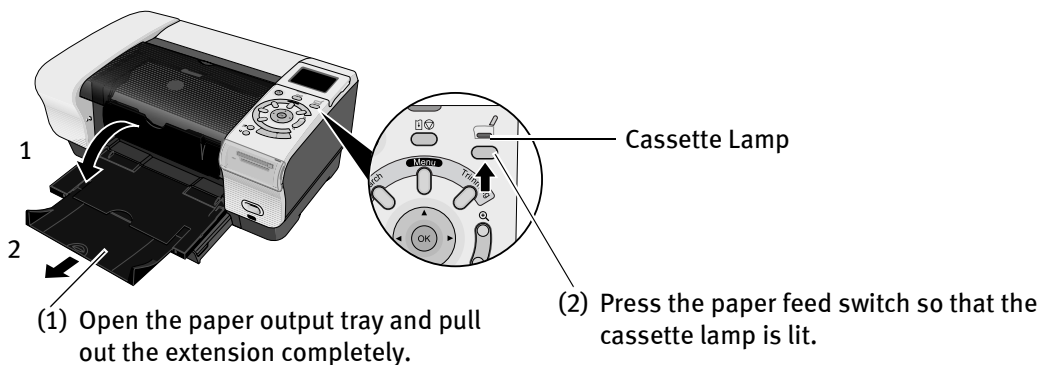

Note Do not touch the printed surface until the ink dries. For specific drying times, refer to the instructions packaged with your media.

■ Media Types for Card Direct Printing

You can use the following Canon media:

Media Type	Paper Support Load Limit	Paper Size	Paper Type
Plain Paper	Letter: Up to 150 sheets	[8.5" x 11"]	[Plain Paper]
Photo Paper Pro	Letter: 10 sheets* ¹	[8.5" x 11"]	[Photo Paper Pro]
	4" x 6": up to 20 sheets	[4" x 6"]	
Photo Paper Plus Glossy	Letter: 10 sheets* ¹	[8.5" x 11"]	[Photo Paper Plus Glossy]
	4" x 6": up to 20 sheets	[4" x 6"]	
	5" x 7": up to 10 sheets	[5" x 7"]	
Photo Paper Plus Semi-gloss	Letter: 10 sheets* ¹	[8.5" x 11"]	[Photo Paper Plus Glossy]
	4" x 6": up to 20 sheets	[4" x 6"]	
Matte Photo Paper	Letter: 10 sheets	[8.5" x 11"]	[Matte Photo Paper]
Glossy Photo Paper	Letter : Up to 10 sheets	[8.5" x 11"]	[Glossy Photo Paper]
	4" x 6": up to 20 sheets	[4" x 6"]	
	Credit Card: Up to 20 sheets	[Credit Card]	
Photo Stickers* ³	1 sheet* ²		

 **Notes** ● When using plain paper (64 gsm or 17 lb) up to 150 sheets can be set.

*¹: When loading Letter size paper in the sheet feeder, do not load the paper all at once. Place the necessary number of sheets (up to 10 sheets) one at a time, to avoid sheets sticking together.

*²: Loadable only in the sheet feeder. Do not load in the cassette.

*³: When printing on sticker paper, select **Sticker print** from Menu. When printing photos in a mobile phone on sticker paper, select **Stickers x16** in the Infrared print screen.

Printing Photograph

Let's select a photo from the photos stored on the memory card of the digital camera and print it.

Printing a Photo Displayed on the LCD - Photo Gallery

1 Turn on the printer.

2 Load the Paper.

See "Loading Paper" on page 15.

3 Ensure the paper source.

Ensure that the proper paper source is selected. Press the paper feed switch to change the paper source.

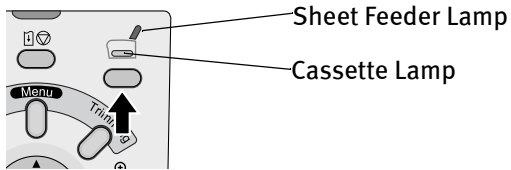

 **Note** Select the sheet feeder when paper is loaded in the sheet feeder, or select the cassette when paper is loaded in the cassette.

4 Insert the memory card in the card slot.

See "Inserting a Memory Card" on page 11.

5 Select the print mode from the **Menu**.

- (1) Press the **Menu** button.
The Menu screen is displayed.



- (2) Use the ◀ ▶ buttons to select **Photo Gallery** and then press the **OK** button.
The Photo Gallery screen is displayed.



 **Note** The watch icon may appear when importing photos from a memory card.

Important If you leave the printer more than 5 minutes without using any button on the operation panel, the LCD goes into screen-saver mode automatically. Press the **OK** button to turn on the LCD again.

6 Select the photo to print.

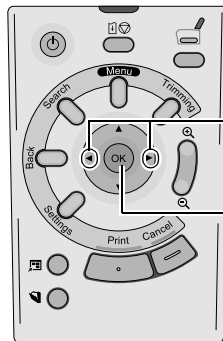

- (1) Using the ◀ ▶ buttons, select the photo to print.
- (2) Press the **OK** button.
The print confirmation screen is displayed.

To zoom in to a photo

Follow the procedure below to zoom in to the photo displayed on the LCD.

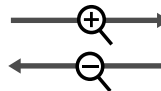
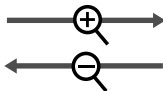
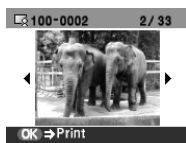

Scroll the photo with ▲ ▼ ◀ ▶ buttons

-
-  **Notes**
- When many photos are stored in a memory card, it is convenient to select photos to display or print using the shooting date as the search key.
See “Searching for Photos with the Shooting Date” on page 30.
 - For each photo selected you can also set the area to print using the Trimming function.
See “Printing a Specified Area – Trimming” on page 32.

7 Confirm the settings.

To change any of the settings, press the Setting button.
See “Changing the Print Settings” on page 27.

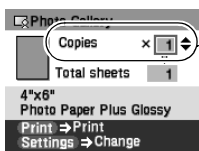

Press the ▲ ▼ buttons to specify the number of copies to print.

8 Start printing.

Press the **Print** button.
The printings start.



Specifying How Many Copies to Print for Each Photo - Photo Print

You can specify how many copies to print for each photo. In addition, you can trim each photo before it is printed.

1 Prepare to print.

- (1) Turn on the printer.
- (2) Load the paper.
See “Loading Paper” on page 15.
- (3) Ensure the paper source.
See page 22.
- (4) Install the memory card into the card slot.
See “Inserting a Memory Card” on page 11.

2 Select the print mode from the **Menu**.

- (1) Press the **Menu** button. The menu listing is displayed.



- (2) Use the ◀ ▶ buttons to select **Photo Print** and then press the **OK** button.
The photo selection screen is displayed.



3 Specify the number of copies to print.

- (1) Using the ◀ ▶ buttons, select the photo you wish to print.



- (2) Use the ▲ ▼ buttons to specify the number of copies to print.

- (3) Repeat steps (1) and (2) and specify the number of copies for each photo you wish to print.
- (4) Press the **OK** button.
The print confirmation screen is displayed.

-
-  **Notes**
- You can zoom in/out on the photo on the LCD using   buttons. See “To zoom in to a photo” on page 23.
 - When many photos are stored in a memory card, it is convenient to search for photos to display or print using the shooting date as the search key. See “Searching for Photos with the Shooting Date” on page 30.
 - If you have specified the number of copies to print for photos before using the search function, the photos will be printed even if they are excluded by the search.
 - For each photo selected you can also set the area to print using the Trimming function. See “Printing a Specified Area – Trimming” on page 32.

4 Confirm the settings.

To change any of the settings, press the **Settings** button.
See “Changing the Print Settings” on page 27.

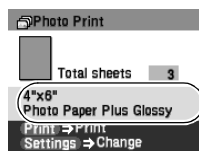

5 Start printing.

Press the **Print** button.
The specified number of copies for each photo will be printed.

Changing the Print Settings

You can change the print settings such as paper size, paper type, bordered or borderless print, etc.

■ To Change Print Settings

This section describes the steps to change the print settings using the Effects setting as an example. For information on each item, see “Print Setting Items” on page 28.

1 Press the **Settings** button.

Print Setting screen is displayed.

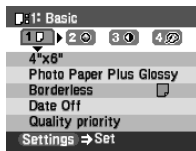

2 Select the Setting tab.

Use the ◀▶ buttons to select the Setting tab.
Select tab 4.

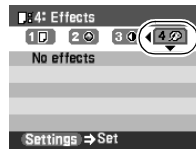

3 Select the setting item.

Use the ▼ buttons to select the setting item.
Select **No effect** here.

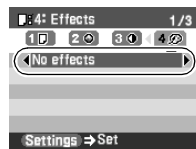

4 Change the setting.

Use the ◀ ▶ buttons to change the setting.
Change to **Sepia** here.

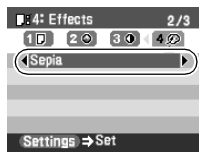

5 Complete setting.

Press the **Settings** button.

■ Print Setting Items

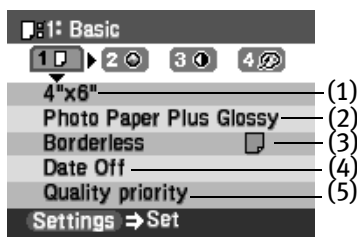

1: Basic

Allows you to set the paper size, paper type, Bordered/Borderless printing, and printing with the date.

(1) Select the paper size.

8.5"x11", 4"x6", 5"x7"

(2) Select the paper type.

Photo Paper Pro, Photo Paper Plus Glossy, Matte
Photo Paper, Glossy Photo Paper, Plain Paper

(3) Select bordered or borderless print.

Borderless/Bordered

(4) Select whether to print the shooting date or not.

Date On/Date Off

(5) Select the printing priority.

Quality Priority/Speed Priority

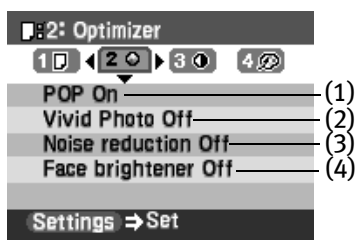

2: Optimizer

Allows you to optimize photos with the functions below.

- (1) Activate/deactivate the Photo Optimizer PRO function.
This function automatically optimizes brightness and tone of a photo.

POP On/POP Off

- (2) Activate/deactivate Vivid Photo function.

This function makes green and blue more lively.

Vivid Photo On/Vivid Photo Off

- (3) Activate/deactivate the Noise reduction function.

This function reduces the noise on blue areas like the sky as well as on black areas.

Noise reduction On/Noise reduction Off

- (4) Activate/deactivate Face brightener function.

This function brightens a darkened face on the photo taken against the light.

Face brightener On/Face brightener Off

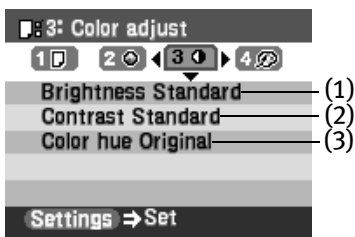

3: Color adjust

Allows you to adjust the brightness, contrast, or color hue of photos.

- (1) Adjust brightness.

Brightness +2, Brightness +1, Brightness Standard, Brightness -1, Brightness -2

- (2) Adjust contrast.

Contrast +2, Contrast +1, Contrast Standard, Contrast -1, Contrast -2

- (3) Adjust color hue.

Color hue Red +2, Color hue Red +1, Color hue Original, Color hue Yellow +1, Color hue Yellow +2

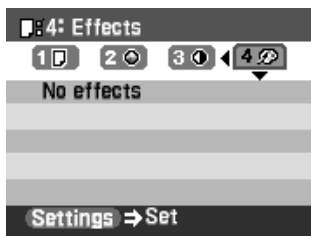

4: Effects

Applying the effect to print a photo in sepia or like an illustration.

No effects, Sepia, Simulate illustration

Other Useful Functions

The following functions are available when printing from a memory card:

- “Searching for Photos with the Shooting Date” on page 30
- “Printing a Specified Area – Trimming” on page 32
- “Specifying the Layout” on page 34
- “Printing on the Sticker – Sticker Print” on page 37
- “Printing in Your Favorite Color Tone – Color Balance” on page 40
- “Printing All Photos” on page 43
- “Printing a Photo List – Print Index” on page 44
- “Printing According to the Settings Made on the Camera – DPOF Printing” on page 45

Searching for Photos with the Shooting Date

When many photos are stored in a memory card, it is convenient to select photos to display or print using the shooting date as the search key.

-  **Notes**
- When selecting the menus below, you can display and print the photos searched for by date:
Photo Gallery, Photo Print, Layout print, Sticker print, and Color balance.
 - If you have specified the number of copies to print for photos, or have pasted photos on a certain layout before using the search function, the photos will be printed even if they are excluded by the search.
 - When selecting Print all or Print index, you can print the photos searched for by date.

1 Press the Search button.

The Search screen is displayed.

- The Search screen may display slowly when the memory card contains many photos or high data photos.

2 Assign the period to search.

- (1) Use the ◀ ▶ buttons to select the earliest shooting date to search.

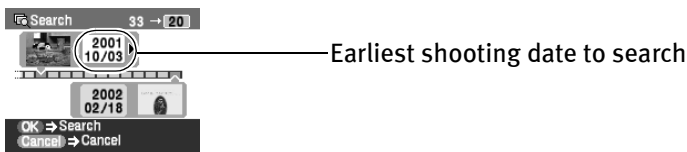

- (2) Press the ▼ button to move the cursor down.

- (3) Use the ◀ ▶ buttons to select the latest shooting date to search.

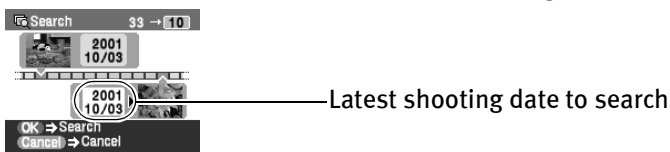

3 Press the OK button.

The photos taken in the assigned period are searched for and displayed.

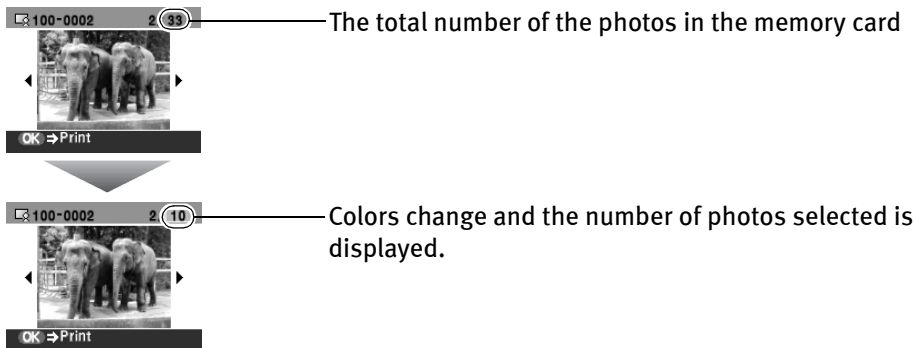

Note To cancel the search mode, follow the procedure below.

1. Press the **Search** button to display the Search screen.
2. Press the **Cancel** button.

The search mode is canceled and all the photos in the memory card can be displayed and printed.

Removing the memory card also cancels the search mode.

Printing a Specified Area – Trimming

You can print a specified area of the photo displayed on the LCD.

 **Note** Please trim the photo after specifying **Paper Size, Paper Type, Borderless/Bordered** on each settings screen. If you change the settings after trimming the photo, the trimmed selection will be lost.

1 Select the photo to trim.

Use the ◀ ▶ buttons to select the photo.

2 Set the Trimming Mode.

Press the **Trimming** button.
The printer is now in Trimming Mode.



3 Trimming and Rotating the Sections you wish to Print.

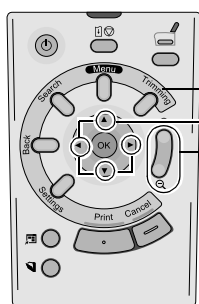

Rotate the trimming area
Using the **Trimming** button, you can rotate the trimming area.

Move the area for trimming
Using the ◀ ▶ ▲ ▼ buttons, you can move the trimming area.

Enlarge/Reduce the area for trimming
Using the 🔍 🔍 buttons, you can enlarge or reduce the trimming area.

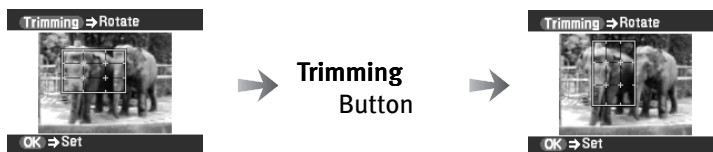

4 Finalize the trimmed area.

- (1) Press the **OK** button.

The trimming area is fixed and the color of the trimming guide changes into yellow.

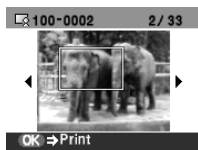

Notes

- Once the trimmed area is finalized, if you press the **Trimming** button again, you can modify the trimmed area.
- If you want to cancel the **Trimming** setting, press the **Trimming** button and then the **Cancel** button in the **Trimming** screen. Removing the memory card also cancels the trimming setting.

Specifying the Layout

You can print the specified photo in the specified layout (Borderless or Bordered x2/x4/x8, postcard, album Mixed).

● Bordered



● Postcard

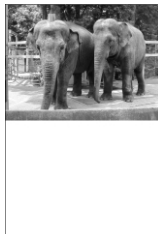

● Album

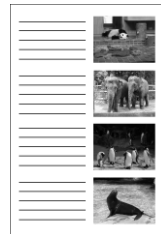

● Borderless



● Postcard with Rule

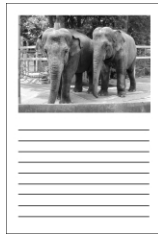

● Mixed



1 Prepare to print.

- (1) Turn on the printer and load the paper.
See “Loading Paper” on page 15.
- (2) Ensure the paper source.
See page 22.
- (3) Insert the memory card into the card slot.
See “Inserting a Memory Card” on page 11.

2 Select the print mode from the **Menu**.

- (1) Press the **Menu** button.
The Menu screen is displayed.

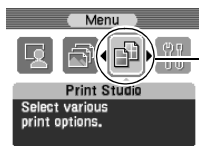

- (2) Use the ◀ ▶ buttons to select **Print Studio** and then press the **OK** button.
The Print Studio screen is displayed.

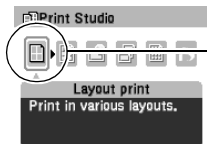

- (3) Use the ◀ ▶ buttons to select **Layout print** and then press the **OK** button.
The Layout print screen is displayed.

3 Specify the layout.

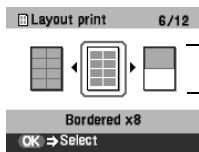

- (1) Press the ◀ ▶ buttons to specify the layout.

- (2) Press the **OK** button.
The paste method screen is displayed.

4 Select the paste method.

- (1) Use the ◀ ▶ buttons, select the paste method.

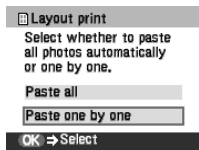

- After selecting **Paste all** and pressing the **OK** button, all the photos in the memory card are pasted into the selected layout. Proceed to step 6.
- After selecting **Paste one by one** and pressing the **OK** button, The photo selection screen is displayed. Proceed to Step 5.

5 Select the photo to print.

- (1) Using the ◀ ▶ buttons, select the photo you wish to print.

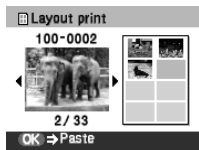

- (2) Press the **OK** button.
- To cancel the last photo selection, press the **Back** button. Each time you press the button, the last photo selection is cancelled.
 - To cancel all the photo selections at once, press the **Cancel** button.
- (3) Repeat steps (1) and (2) for each photo you wish to print.
- (4) Press the **Print** button.
The print confirmation screen is displayed.

-  **Notes**
- You can zoom in/out on the photo on the LCD using ⌕ 🔍 buttons. See “To zoom in to a photo” on page 23.
 - When many photos are stored in a memory card, it is convenient to search for photos to display or print using the shooting date as the search key. See “Searching for Photos with the Shooting Date” on page 30.
 - If you have pasted photos before using the search function, the photos will be printed even if they are excluded by the search.
 - For each photo selected you can also set the area to print using the Trimming function. Trim the photo after specifying paper size, paper type, and bordered/borderless print. See “Printing a Specified Area – Trimming” on page 32.

6 Start printing.

- (1) Confirm the print settings.
To change any of the settings, press the **Settings** button.
See “Changing the Print Settings” on page 27.

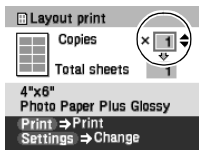

- (2) Press the **Print** button.
The specified number of copies for each photo will be printed.

Printing on the Sticker – Sticker Print

You can print your favorite photo on the Canon-Brand sticker.

1 Prepare to print.

- (1) Turn on the printer and load a sheet of sticker paper in the sheet feeder.
See “Loading Paper” on page 15.

Caution You cannot load sticker paper in the cassette. Load one sheet at a time in the sheet feeder.

- (2) Ensure the sheet feeder is selected as the paper source.
See page 22.
- (3) Insert the memory card into the card slot.
See “Inserting a Memory Card” on page 11.

2 Select the print mode from the Menu.

- (1) Press the **Menu** button.
The Menu screen is displayed.

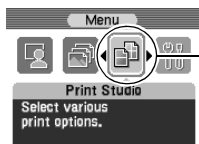

- (2) Use the ◀ ▶ buttons to select **Select Print Studio** and then press the **OK** button.
The Print Studio screen is displayed.

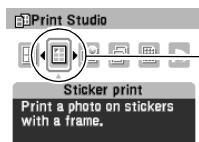

- (3) Use the ◀ ▶ buttons to select **Sticker print** and then press the **OK** button.
The Sticker print screen is displayed.

3 Specify the layout.

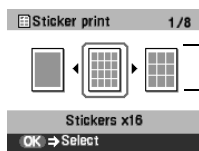

- (1) Press the ◀ ▶ buttons to select **Stickers x16**.
You can only print in the Stickers x16 layout though other layouts appear on the LCD.



- (2) Press the **OK** button.
The photo selection screen is displayed.

4 Select the photo to print.

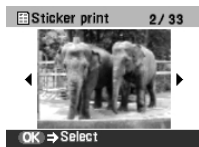
- (1) Using the ◀ ▶ buttons, select the photo you wish to print.





- (2) Press the **OK** button.
The frame selection screen is displayed.

-  **Notes**
- You can zoom in/out on the photo on the LCD using   buttons. See “To zoom in to a photo” on page 23.
 - When many photos are stored in a memory card, it is convenient to search for photos to display or print using the shooting date as the search key. See “Searching for Photos with the Shooting Date” on page 30.
 - For each photo selected you can also set the area to print using the Trimming function. Trim the photo after specifying paper size, paper type, and bordered/borderless print. See “Printing a Specified Area – Trimming” on page 32.

5 Select the frame.

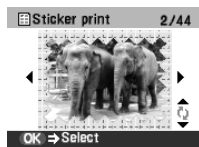
- (1) Using the ◀ ▶ buttons, select the frame you wish.



-  **Notes**
- When the photo is upside down in the frame, you can press the ▲ ▼ button to orient the photo correctly.
 - You can rotate photos in the trimming mode to fit them to the vertical portrait frame.

- (2) Press the **OK** button.
The print confirmation screen is displayed.

6 Start printing.

- (1) Confirm the print settings.

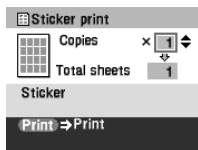

- (2) Press the **Print** button.
The specified number of copies for each photo will be printed.

Caution You cannot load sticker paper in the cassette. Load one sheet at a time in the sheet feeder.

Printing in Your Favorite Color Tone – Color Balance

You can print 9 color balance sample photos on a sheet of paper and select a color tone you like from them before printing.

1 Prepare to print.

- (1) Turn on the printer and load the paper.
See “Loading Paper” on page 15.
- (2) Ensure the paper source.
See page 22.
- (3) Insert the memory card into the card slot.
See “Inserting a Memory Card” on page 11.

2 Select the print mode from the **Menu**.

- (1) Press the **Menu** button.
The Menu screen is displayed.



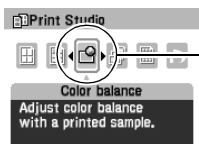

- (2) Use the ◀ ▶ buttons to select **Print Studio** and then press the **OK** button.
The Print Studio screen is displayed.



- (3) Use the ◀ ▶ buttons to select **Color balance** and then press the **OK** button.
The photo selection screen is displayed.



3 Select the photo to print.

- (1) Use the ◀ ▶ buttons to select the photo you wish to print.
- (2) Press the **OK** button.
The Sample print screen is displayed.

-  **Notes**
- You can zoom in/out on the photo on the LCD using   buttons. See “To zoom in to a photo” on page 23.
 - When many photos are stored in a memory card, it is convenient to search for photos to display or print using the shooting date as the search key. See “Searching for Photos with the Shooting Date” on page 30.
 - For each photo selected you can also set the area to print using the Trimming function. Trim the photo after specifying paper size, paper type, and bordered/borderless print. See “Printing a Specified Area – Trimming” on page 32.

4 Print the color balance sample.

If you have already printed the color balance sample (ex. when choosing another color tone of a certain photo), select **No** to proceed to step 5.

- (1) Use the   buttons, select **Yes**.

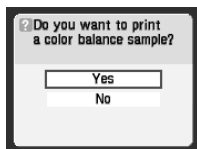

- (2) Press the **OK** button.
The print confirmation screen is displayed.

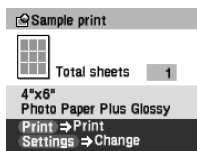

- (3) Confirm the print settings.
To change any other settings, press the **Settings** button.

- (4) Start printing the color balance sample.
Press the **Print** button.
Printing the color balance sample starts.

 **Note** Since the ink takes a few minutes to set on some types of paper, wait for a short while before going to Step 5.

5 Select the Color Balance.

The color balance selection screen appears on the LCD after printing the sample. Select the number of the sample photo you like.

- (1) Use the ◀ ▶ ▲ ▼ buttons to select the number of the sample photo you like.

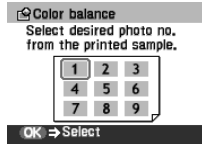

- (2) Press the **OK** button.
The print confirmation screen is displayed.

6 Start printing.

- (1) Confirm the print settings.
To change any of the settings, press the **Settings** button.
See “Changing the Print Settings” on page 27.

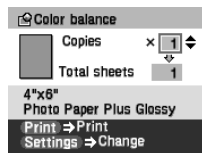

- (2) Use the ▲ ▼ buttons to specify the number of copies.

- (3) Press the **Print** button.
The specified number of copies for each photo will be printed.

Printing All Photos

You can print all photos saved on a memory card.

1 Prepare to print.

- (1) Turn on the printer and load the paper.
See “Loading Paper” on page 15.
- (2) Ensure the paper source.
See page 22.
- (3) Insert the memory card into the card slot.
See “Inserting a Memory Card” on page 11.

2 Select the print mode from the **Menu**.

- (1) Press the **Menu** button.
The Menu screen is displayed.



- (2) Use the ◀ ▶ buttons to select **Print Studio** and then press the **OK** button.
The Print Studio screen is displayed.

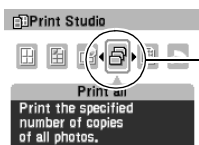

- (3) Use the ◀ ▶ buttons to select **Print all** and then press the **OK** button.
The print confirmation screen is displayed.

3 Start printing.

- (1) Confirm the print settings. To change any of the settings, press the **Settings** button.
See “Changing the Print Settings” on page 27.

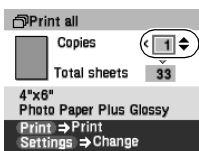

- (2) Use the ▲ ▼ buttons to specify the number of copies to print.

- (3) Press the Print button.
All photos saved on the memory card will be printed.

Printing a Photo List – Print Index

You can print an index of all photos saved in the memory card known as an index print.

1 Prepare to print.

- (1) Turn on the printer and load the paper.
See “Loading Paper” on page 15.
- (2) Ensure the paper source.
See page 22.
- (3) Insert the memory card into the card slot.
See “Inserting a Memory Card” on page 11.

2 Select the print mode from the **Menu**.

- (1) Press the **Menu** button.
The Menu screen is displayed.

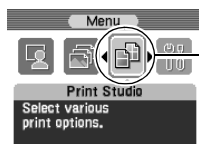

- (2) Use the ◀ ▶ buttons to select **Print Studio** and then press the **OK** button.
The Print Studio screen is displayed.



- (3) Use the ◀ ▶ buttons to select **Print index** and then press the **OK** button.
The print confirmation screen is displayed.

3 Start printing.

- (1) Confirm the print settings.
To change any of the settings, press the **Settings** button.
See “Changing the Print Settings” on page 27.

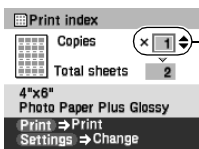

- (2) Use the ▲ ▼ buttons to specify the number of copies to print.

- (3) Press the **Print** button.
An index of all photos saved on the memory card will be printed.

Printing According to the Settings Made on the Camera

– DPOF Printing

If DPOF (Digital Print Order Format) settings are made on the camera, photos are printed automatically according to those settings.



Notes

- This printer allows you to make the following DPOF settings:
 - Image format: CIFF, Exif (JPEG), JFIF, and Exif (Tiff)
 - Print type - Standard: The photos for which you specified “Standard” using the DPOF function are printed.
 - Print type - Index: The photos for which you specified “Index” using the DPOF function are printed according to the index print layout.
 - Photos to Print: Only the photos specified using the DPOF function are printed (photos cannot be specified on the operation panel).
 - Copies: Photos are printed according to the numbers of copies specified using the DPOF function (numbers of copies cannot be specified on the operation panel).
 - Other functions (addition of comments, trimming/rotation, etc.) are not supported.
- Photos are automatically scaled according to the paper size. The upper, lower, left, and/or right portion(s) of the photo may be missing depending on the size of the paper you use.
- The shooting date format is as specified in the DPOF setting from DPOF printing.

1 Prepare to print.

- (1) Turn on the printer and load the paper.
See “Loading Paper” on page 15.
- (2) Ensure the paper source.
See page 22.
- (3) Insert the memory card containing DPOF information into the card slot.
See “Inserting a Memory Card” on page 11.

2 Set the DPOF mode.

- (1) Press the **Menu** button.
The Menu screen is displayed.

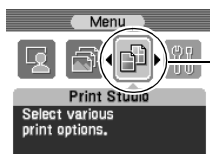

- (2) Use the ◀ ▶ buttons to select **Print Studio** and then press the **OK** button.
The Print Studio screen is displayed.

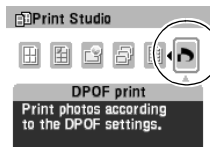

- (3) Use the ◀ ▶ buttons to select **DPOF print** and then press the **OK** button.
The print confirmation screen is displayed.

3 Start printing.

- (1) Confirm the print settings.
To change any of the settings, press the **Settings** button.
See “Changing the Print Settings” on page 27.

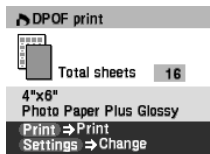

- (2) Press the **Print** button.
The photos will be printed according to the DPOF information on the memory card.

Changing Other Settings

This section explains the setting items in the Tool Box menu below.

- “Adjusting Contrast of the LCD” on page 47
- “Reducing the Sound of Printer Operation” on page 48
- “Setting the Date Display Format” on page 49
- “Resetting All the Settings” on page 50
- “Changing the Language Displayed” on page 51

Adjusting Contrast of the LCD

You can adjust contrast of the LCD, if it is too high or too low.

- 1 Turn on the printer.
- 2 Select **Tool Box** from the **Menu**.

(1) Press the **Menu** button.

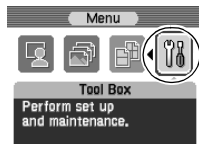

- (2) Use the ◀ ▶ buttons to select **Tool Box** and then press the **OK** button.
The Tool Box screen is displayed.

- 3 Select **Contrast**.

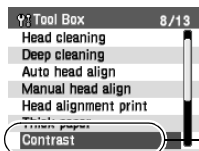

- (1) Use the ▲ ▼ buttons to select **Contrast** and then press the **OK** button.
The Contrast setting screen is displayed.

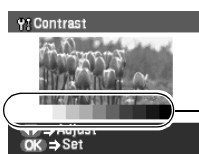

- (2) Pressing the ◀ button increases contrast.
Pressing the ▶ button decreases contrast.
- (3) After adjusting contrast at your discretion, press the **OK** button.
The LCD display will be changed to the adjusted contrast.

Reducing the Sound of Printer Operation

The Quiet Mode allows you to significantly reduce the sound the printer generates during operation. It is ideal when working at night or in crowded environments.

- Important**
- Print speed may be somewhat slower than in the normal operating mode.
 - Sound reduction is not as effective when certain printing options are selected. Sound generated during printer warm up is the same as during normal operation.
 - The following operations are effective only when you are printing from a memory card or from a digital camera connected to this printer. If you are printing with your computer connected, specify the required settings in the Printer Driver.

1 Turn on the printer.

2 Select **Tool Box** from the **Menu**.

(1) Press the **Menu** button.

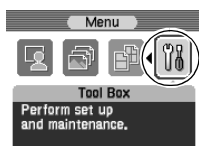

(2) Use the ◀ ▶ buttons to select **Tool Box** and then press the **OK** button.
The Tool Box screen is displayed.

3 Select **Quiet mode**.

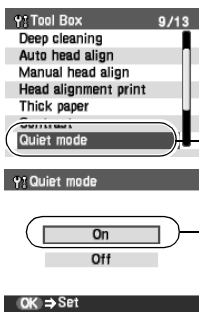

(1) Use the ▲ ▼ buttons to select **Quiet mode** and then press the **OK** button.
The Quiet mode setting screen is displayed.

(2) Use the ▲ ▼ buttons to select **On** and then press the **OK** button.

Setting the Date Display Format

You can change the format for printing the date.

 **Note** The shooting date format is as specified in the DPOF setting from DPOF printing.

- 1 Turn on the printer.
- 2 Select **Tool Box** from the **Menu**.

(1) Press the **Menu** button.

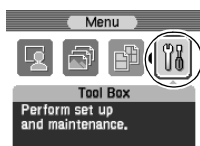

(2) Use the ◀ ▶ buttons to select **Tool Box** and then press the **OK** button.
The Tool Box screen is displayed.

- 3 Select **Date display format**.

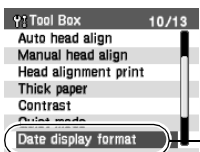

(1) Use the ▲ ▼ buttons to select **Date display format** and then press the **OK** button.
The Date display format setting screen is displayed.

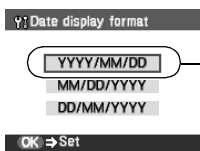

(2) Use the ▲ ▼ buttons to select date display format and then press the **OK** button.
The shooting date is printed in the selected format when you selected **Date On** in the Print Settings.

Resetting All the Settings

You can reset all settings, other than the display language and the print head position, to the initial state.

- 1 Turn on the printer.
- 2 Select **Tool Box** from the **Menu**.

(1) Press the **Menu** button.

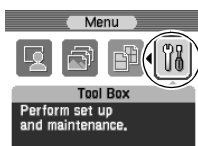

(2) Use the ◀ ▶ buttons to select **Tool Box** and then press the **OK** button.
The Tool Box screen is displayed.

- 3 Select **Reset**.

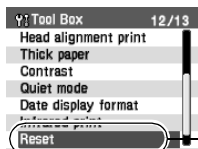

(1) Use the ▲ ▼ buttons to select **Reset** and then press the **OK** button.
The Reset screen is displayed.

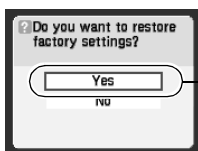

(2) Use the ▲ ▼ buttons to select **Yes** and then press the **OK** button.

Changing the Language Displayed

You can change the language displayed on the LCD.

1 Turn on the printer.

2 Select **Tool Box** from the **Menu**.

(1) Press the **Menu** button.



(2) Use the ◀ ▶ buttons to select **Tool Box** and then press the **OK** button.
The Tool Box screen is displayed.

3 Select a language for display.

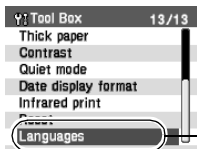

(1) Use the ▲ ▼ buttons to select **Languages** and then press the **OK** button.
The language selection screen is displayed.



(2) Use the ◀ ▶ ▲ ▼ buttons to select a language and then press the **OK** button.
The menu, selection items, and messages will be displayed in the language you select.

Printing Photographs Directly from a Digital Camera

Connecting a compatible digital camera or camcorder to the printer allows you to print recorded photos directly without using a computer. This printer supports both PictBridge and Canon Bubble Jet Direct.

-  **Notes**
- PictBridge is an industry standard enabling a range of digital photo solutions, including the direct printing of photos from compatible digital still cameras or camcorders* without the need to use a computer.
 - Canon Bubble Jet Direct allows you to print photos from Canon Bubble Jet Direct compatible (PictBridge incompatible) digital camera or digital camcorder without a computer, by simply connecting the digital camera or digital camcorder to this printer.
- *Hereafter, the digital still camera and digital video camcorder are collectively called a digital camera or camera.

Connecting to a Digital Camera

Do not connect any equipment other than the camera ready for PictBridge or Canon Bubble Jet Direct to the Direct Print Port of the printer. If you do so, electric shock, fire, or damage to the camera could result.

-  **Notes**
- When printing photos with the digital camera connected to the printer, it is advisable to use the AC adapter supplied with the camera. If you use the camera battery, be sure to charge it fully.
 - Depending on the model or brand of your camera, you may have to select a print mode compliant with PictBridge before connecting the camera. You may also have to turn on the camera or select Play mode manually after connecting the camera to the printer. Perform necessary operations according to the instruction manual supplied with your camera.
 - When printing from your PC, be sure to unplug the cable connecting the digital camera.

1 Turn on the printer.

Make sure the camera is turned off.

2 Load the paper in the printer.

See “Loading Paper” on page 15.

3 Ensure the paper source.

See page 22.

4 Connect the digital camera to the printer.

- (1) Connect the camera to the printer using the USB cable (for connection to a computer) supplied with the camera.
- (2) Turn on and set up the camera for direct printing.
When the connection between the camera and printer has been established, the POWER lamp on the printer flashes once.

* The power-on sequence may differ depending on the model or brand of the camera.

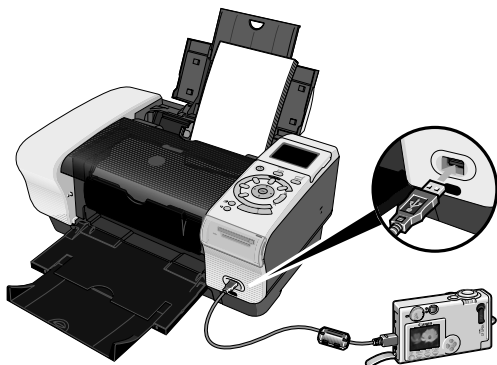

Either of the following icons will display on the LCD display of the digital camera when the printer is correctly connected.



A PictBridge-compliant digital camera.

* This mark indicates that the product is PictBridge-compatible.



A Canon Bubble Jet Direct compatible digital camera.

Direct Printing from PictBridge-compatible Digital Cameras

■ Confirming or Changing the Camera Settings

To change the paper size or paper type, operate the camera to select the PictBridge print setup mode and confirm or change the settings.

The settings below can be changed by pressing the “Settings” button when the camera is connected. However, changes can be made on in the properties screen only when the corresponding items below are in the “Default Setting” (selections based on the printer setting) using the controls of the camera.

- Paper size
- Paper type
- Layout
- Image Optimize

About the Settings Explained Below

The settings explained on the following pages cannot be made on some cameras. If any setting cannot be made, printing will be based on the “Default Setting” specified with. The items which the “Default Setting” is set will be printed based on the current printer setting.

Names of settings that are displayed on Canon PictBridge-compliant cameras are used in the description given below.

Different names may be displayed on your camera depending on the brand or model. For details, refer to your camera’s instruction manual.

■ About “Paper size” and “Paper type”

When you have selected the **“Default setting”** (selections based on the printer setting), the printer operates based on the **“Paper Size”** and the **“Paper Type”** settings made using the controls of the printer.

The following sizes and types of paper can be loaded in the printer by selecting options in **“Paper Size”** and **“Paper Type”**.

“Paper size” setting	“Paper type” setting	Paper loaded in printer
4" x 6"	Photo	Photo Paper Plus Glossy
	Fast Photo	Photo Paper Pro
	Photo	Photo Paper Plus Semi-gloss
5" x 7"	Photo	Photo Paper Plus Glossy
Credit Card	Photo	Glossy Photo Paper Credit Card
Letter	Photo	Photo Paper Plus Glossy
	Photo	Photo Paper Plus Semi-gloss
	Fast Photo	Photo Paper Pro
	Photo	Glossy Photo Paper

■ About “Layout”

When “Default setting” (selections based on the printer setting) is selected, the printer operates based on the “Borderless Printing” setting made using the controls of the printer.

When **4" x 6"** is selected from **“Paper size”**, “2-up”, “4-up”, “9-up”, and “16-up” options may be available in **“Layout”**.

■ About “Image optimize”

When “Default setting” (selections based on the printer setting) is selected, the printer operates based on the settings in the “Optimizer”, “Color adjust”, and “Effects” setting menus of the printer.

If you use a Canon PictBridge-compliant camera, you can select “VIVID”, “NR”, or “VIVID+NR”. (Note that these options cannot be selected for some models.)

-  **Notes**
- When “VIVID” is selected, green and blue portions of photos are printed vividly.
 - When “NR” (Noise Reduction) is selected, noise in blue portions, such as the sky, and dark portions is removed.
 - When “VIVID+NR” is selected, functions of both “VIVID” and “NR” are performed.

■ About “Date print”

“Date Print” depends on the settings made using the controls of the camera.

-  **Notes**
- This printer can handle only Exif/JPEG image data to produce photos using PictBridge.
 - Never disconnect the USB cable during printing.
 - When disconnecting the USB cable between the digital camera and printer, follow the instructions given in the Instruction Manual of the camera.
 - Controls of the digital camera cannot be used for the following:
 - Print quality setting
 - Printer maintenance
 - For the digital camera operation method and troubleshooting, refer to your digital camera’s manual.

Printing Photographs Directly from a Canon Bubble Jet Direct Compatible Digital Camera

■ Media Types for Digital Camera

When you connect a digital camera, you can use the following media:

Digital Camera Setting	Media Type
Card #1	Photo Paper Pro 4" x 6"
Card #2	Photo Paper Plus Glossy 4" x 6"
	Photo Paper Plus Semi-gloss 4" x 6"
	Glossy Photo Paper 4" x 6"
Card #3	Photo Paper Plus Glossy 5" x 7"
LTR	Photo Paper Pro Letter size
	Photo Paper Plus Glossy Letter size
	Photo Paper Plus Semi-gloss Letter size
	Glossy Photo Paper Letter size
A4	Photo Paper Pro A4 size
	Photo Paper Plus Glossy A4 size
	Photo Paper Plus Semi-gloss A4 size
	Glossy Photo Paper A4 size

-  **Notes**
- For the digital camera operation method and troubleshooting, refer to your digital camera's manual.
 - By operating the digital camera, you can make the following prints:
 - You can make a standard print from the photo displayed in the single display mode or in the index display mode.
 - You can print specified numbers of photos, or make an index print by editing the DPOF.
 - For the photos taken with an ExifPrint-compatible digital camera, the Photo Optimizer PRO function can be used.
 - If date printing is set from the digital camera, the date when the photograph was taken is to be printed (excluding the index print).
 - Photos will be scaled automatically according to the image size set on the digital camera and the size of the media set on the printer.
 - The digital camera does not support the following functions:
 - Print quality setting
 - Printer maintenance
 - Photos other than Exif may not be index-printed.

Printing Photos in the Mobile Phone through Infrared Communication – Printbeam

If you have a mobile phone with an infrared port for wireless data transmission, you can print photos through a cordless connection with the printer. You can print photos received from a mobile phone in specified format through infrared communication.

Requirements for Infrared Communication

In order to use infrared communication, your mobile phone must satisfy the following requirements:

- Compatible mobile phone:
A mobile phone which has IrDA 1.2 port and supports IrMC ver. 1.1
- Printable contents: photo (JPEG only)

 **Note** IrDA (Infrared Data Association) is the name of the Association that sets and supports hardware and software standards which create infrared communication links. The IrDA standard is the de facto standard of the infrared communication and the word IrDA is used as the infrared interface name.

Setting the Media Type, Paper Size, and Layout When Printing From a Mobile Phone

You can select the media type, page size, layout and borderless printing when printing from a mobile phone.

* The initial setting is borderless printing on 4"x6" Photo Paper Plus Glossy.

- 1** Turn on the printer.

2 Select **Tool Box** from the Menu.

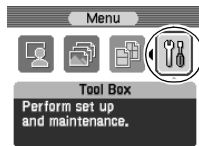

- (1) Use the ◀ ▶ buttons to select **Tool Box** and then press the **OK** button.
The Tool Box screen is displayed.

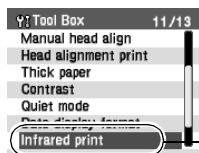

- (2) Use the ▲ ▼ buttons to select **Infrared print** and then press the **OK** button.
The Infrared print screen is displayed.

3 Confirm or change the settings.

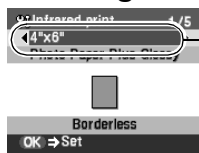

- (1) Use the ▲ ▼ buttons to select the item to set.
(2) Use the ◀ ▶ buttons to change the setting.
(3) Press the **OK** button after finishing all settings you need.
The photos in the mobile phone can be printed following the settings.

■ Setting Items

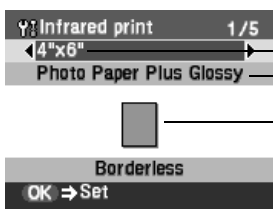

- (1) Select the paper size for the Infrared print.
(2) Select the paper type for the Infrared print.

Note For information on Infrared print compatible paper size and type, see “Media Types for Card Direct Printing” on page 21.

- (3) Select the layout of photos as below.
Sticker print:
Stickers x 16 and Mixed 1, 2, 3, 4.
Printing on paper other than sticker:
Bordered x 1, x 2, x 4, x 8
Borderless x 1, x 2, x 4, x 8.

Note When printing on Canon-brand Sticker, make the settings as below.

Media Type	Paper Size	Paper Type	Layout
[Photo Stickers]	Sticker	Photo Paper Plus Glossy	Photo x 16

Performing Infrared Communication

You can print photos in your mobile phone.

When performing infrared communication, also refer to your mobile phone manual.

1 Prepare to print.

- (1) Turn on the printer and load the paper.
See “Loading Paper” on page 15.
- (2) Ensure the paper source.
See page 22.

2 Start Infrared Communication.

- (1) Oppose the infrared port of the mobile phone to that of the printer at a distance of less than 8 inches.

 **Note** The effective angle of the infrared port of the printer is about 10° from the central axis in both vertical and horizontal directions.
The allowable distance of communication with the printer depends on the mobile phone you use. For this distance, refer to your mobile phone manual.

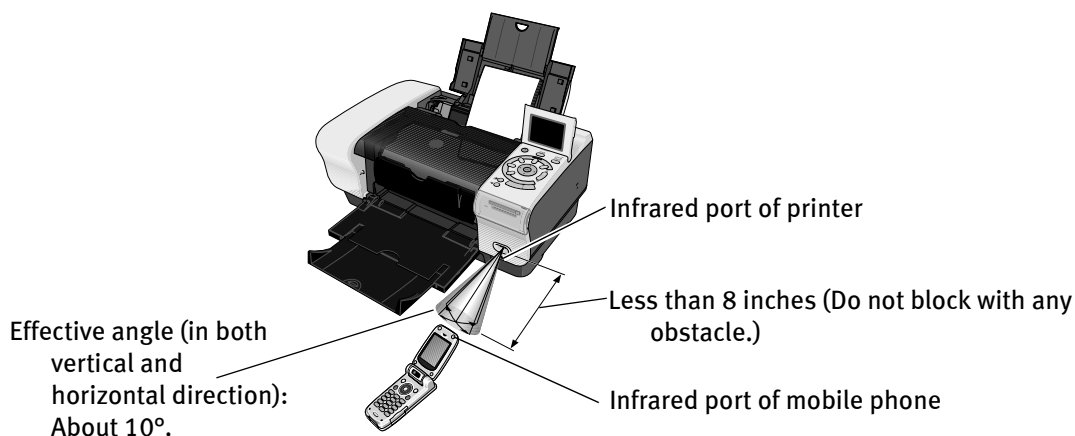

- (2) Select the photo to print and send the data to the printer using the infrared communication function of the mobile phone.

The POWER lamp on the printer flashes in green when received the data properly.

Printing will start after receiving all data.



Notes

- For the procedure to print from your mobile phone, refer to your mobile phone manual.
- Do not place any obstacle between the infrared ports of the printer and mobile phone. Data cannot be transmitted between them.
- During printing, be careful not to interrupt infrared communication with the printer. If it is interrupted, turn off the printer and cancel printing on the mobile phone.
- Following limitations apply on transmittable data.
 - It does not support printing a downloaded content or photo and a photo attached to an email for security reason.
 - It does not support printing video files.
- Depending on your device, the Fine print quality option may not be available due to the restriction on the infrared transfer capacity.
- Depending on your device, it may not print data stored in a memory card.
- Depending on the size of a photo, it may take a while for this printer to start to print after starting the infrared transfer.
- It automatically sets the photo quality and orientation (horizontal or landscape) according to the photo size.
- It automatically sets to the margin according to the photo size.
- We recommend printing on sticker or credit card sized paper when the print quality on other types of paper is not fine.

Using Data in the Memory Card on the Computer

Browsing Photos in the Memory Card on the Computer

By pressing the Easy-PhotoPrint Startup button, you can display photos in the memory card on the computer display with Easy-PhotoPrint, if the printer is connected to the computer. You can print the photos from Easy-PhotoPrint.

Important To use the Easy-PhotoPrint Startup button, connect the printer to the computer and install the printer driver, Memory Card Utility, and Easy-Photo Print. For more information on installation, refer to the *Quick Start Guide*.

- 1** Ensure that the printer and the computer are turned on.
- 2** Press the **Easy-PhotoPrint Startup** button.

Easy-PhotoPrint starts on the computer.

-  **Notes**
- For information on printing with Easy-PhotoPrint and other details, refer to the *Photo Application Guide*.
 - Easy-PhotoPrint displays only the selected photos when you have selected photos using the search function. For the information about the search function, refer to “Searching for Photos with the Shooting Date” on page 30.

Saving Data in the Memory Card onto the Computer

By pressing the Save button, you can save the data in the memory card on the hard disk of the computer.

Important To use the Save button, connect the printer to the computer and install the Memory Card Utility. For more information on installation, refer to the *Quick Start Guide*.

1 Ensure that the printer and the computer are turned on.

2 Press the **Save** button.

The photos will be saved in the location specified below. A folder will be created with a name and the date of the photos were saved (YYYY_MM_DD).

Windows XP/Windows 2000/Windows Me: **My Pictures** folder

Windows 98: **My Documents** folder

Mac OS X v.10.2.1 to 10.3: **Pictures** folder

Mac OS 9.x: Desktop

Setting up the Card Slot as the Memory Card Drive of the Computer

The card slot of the printer can also be used as the memory card drive of the computer.

- Important**
- To use the card slot of the printer as the memory card drive of the computer, the printer must be connected to the computer and the Memory Card Utility must have been installed in the computer. If the utility is not installed, install it following the installation procedure explained in the *Quick Start Guide*.
 - When **Read/write mode** is selected, neither printing nor maintenance can be done.
- After you are finished with using the card slot as a memory card drive for your computer, be sure to select **Read-only mode** again.

Windows

- 1 Ensure that the printer and the computer are turned on.
- 2 Open the USB memory card setup window.
 - (1) Ensure that no memory card is inserted in the card slot. If a memory card is inserted in the card slot, remove it. See “Removing a Memory Card” on page 13.
 - (2) Select **All Programs** (or **Program**) from the **Start** menu. Next, select **Canon Utilities, PIXMA iP6000D Memory Card Utility**, and then **USB Memory Card Settings**.
The **USB Memory Card Settings** window appears.
- 3 Specify the read/write attribute.
 - (1) Click **Next**.
The **Read/write attribute setting** window appears.

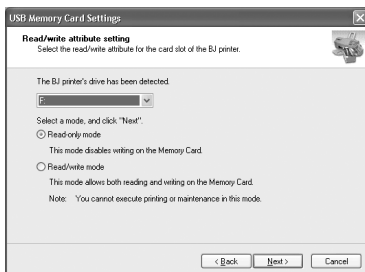

- (2) Specify the read/write attribute.
 - Read-only mode**
...The card slot is used only for reading.
Be sure to select this mode when printing photos.
 - Read/write mode**
...The card slot is used as the memory card drive of the computer. Photo data can be written into the memory card.
- (3) Click **Next**.
When you have selected **Read/write mode**, read the precaution and click **Next**.
- (4) Click **Complete**.
The selected read/write attribute is saved.

1 Ensure that the printer and the computer are turned on.

2 Start the Memory Card Utility.

- (1) Ensure that no memory card is inserted in the card slot. If a memory card is inserted in the card slot, remove it. See “Removing a Memory Card” on page 13.
- (2) Double-click the hard disk icon where the printer driver was installed, and then the **Applications** (or **Applications (Mac OS 9)**) folder.
- (3) Double-click **PIXMA iP6000D Memory Card Utility**.

The Memory Card Utility starts.

3 Specify the read/write attribute.

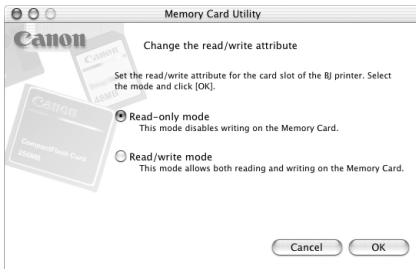

- (1) Specify the read/write attribute.

Read-only mode

...The card slot is used only for reading.

Be sure to select this mode when printing photos.

Read/write mode

...The card slot is used as the memory card drive of the computer. Photo data can be written into the memory card.

- (2) Click **OK**.

The selected read/write attribute is saved.

Replacing an Ink Tank

When replacing an ink tank, check the model number very carefully. The printer will not print properly if the wrong ink tank is used, or installed in the incorrect position.

With this printer, ink tanks must be installed from the right in the order indicated below.

Magenta:
BCI-6M



PhotoMagenta:
BCI-6PM



Yellow:
BCI-6Y



Black:
BCI-6BK



Cyan:
BCI-6C



Photo Cyan:
BCI-6PC



 **Note** Be sure to install the ink tanks in the correct order. The proper arrangement from the left is Photo Cyan, Cyan, Black, Yellow, Photo Magenta, Magenta.

Knowing When to Replace Ink Tank

If an ink tank needs replacing, the **POWER** lamp will change from green to orange and flash four times as soon as printing begins. It is important to identify the empty tank using the LCD and replace it.

 **Note** Should missing characters or white streaks appear despite sufficient ink levels, see “When Printing Becomes Faint or Colors are Incorrect” on page 70.

The following message appears on the LCD when ink is empty.
Printing will resume as soon as ink tank is replaced and the cover is closed.



The ink tank with  symbol is out of ink. Replace with a new ink tank.

- Press the **Cancel** button to cancel the current print job.
 - Press the **RESUME** button to resume printing with an empty ink tank.
- When printing is finished, replace the ink tank immediately. If you continue printing with an empty ink tank, it will be a cause of trouble.

Notes

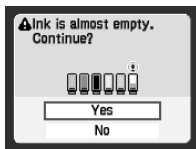

When Low Ink is Detected

When printing starts, the message is displayed on the LCD.

[!] indicates a low ink level. Obtain a replacement tank as soon as possible.

- To continue printing, select **Yes** and then press the **OK** button.
- To cancel printing, select **NO** and then press the **OK** button.

Replacing Ink Tanks

When ink tanks run out of ink, replace them using the following steps.

- 1** Ensure that the printer is on, and then open the cover.
The print head holder moves to the center.
- 2** Open the paper output tray and pull down to open the inner cover forward.
- 3** Remove the empty ink tank.
(1) Push the tab and remove the ink tank.

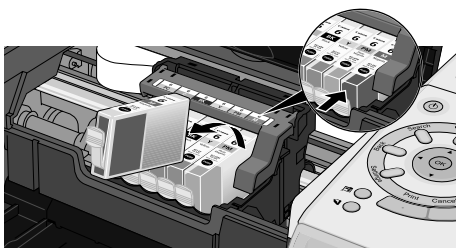

Do not touch the print head lock lever; remove only the ink tank.

- Important**
- Handle ink tanks carefully to avoid staining clothing or the surrounding area.
 - Discard empty ink tanks according to the local laws and regulations regarding disposal of consumables.

4 Prepare a replacement tank.

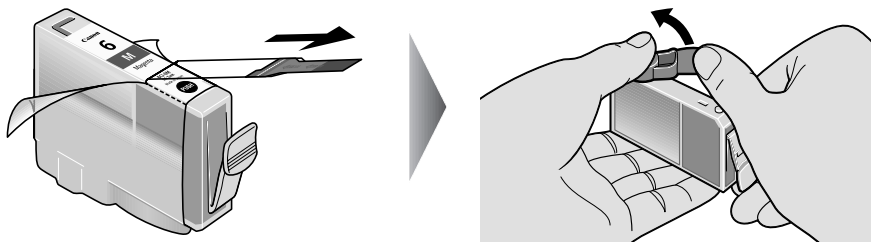

- (1) Unpack the new ink tank and pull off the orange tape.
- (2) Remove the orange protective cap from the bottom of the ink tank and discard it.

- Important**
- Be sure to remove the clear film from the ink tank in the exact order shown in step 4-(1), as failure to follow this step may cause the ink to leak and stain your clothes and hands.
 - Do not squeeze the side of ink tanks as this may cause the ink to leak out and stain your clothes and hands.
 - Do not re-attach the protective cap once you have removed it.
 - Once the protective cap is removed, do not touch the open ink port.
 - Ensure that all the orange tape has been peeled off along the perforation. If there remains a part of the orange tape, ink may not be ejected correctly.

5 Install the ink tank.

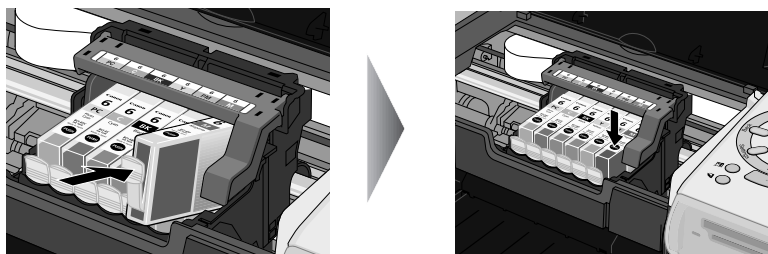

- (1) Insert the ink tank in the print head holder.
- (2) Press on the "PUSH" mark until the ink tank snaps firmly into place.

6 Close the inner cover.

Ensure that the inner cover is completely closed. Printing will not occur if the inner cover is open.



7 Close the cover.

The print head holder moves to the right. The ink tank installation process is now complete.



Notes

- To maintain optimal Print Quality, use an ink tank within six months of first use.
- Once an ink tank has been used, do not remove it from the printer and leave it out in the open. An ink tank left out in the open and then reinstalled in the printer may not function.
- Color ink consumption may occur even when black-and-white or grayscale printing is specified.
Color ink is consumed in the head cleaning and deep cleaning, which are necessary to maintain the printer's capabilities.
- When you start printing after replacing the ink tank, the printer executes print head cleaning automatically. Do not perform any other functions until the print head cleaning finishes. The POWER lamp flashes during cleaning.

Printing Maintenance

When Printing Becomes Faint or Colors are Incorrect

When printing becomes faint or colors are incorrect, even if ink remains in the ink tanks, the print head nozzles are probably clogged. Follow the procedures below to clean the nozzles.

If the ruled lines are shifted after running the print head maintenance, align the print head.

Important Before printing the nozzle check pattern or cleaning the print head, check the following:

- Open the cover and make sure whether the ink tank contains ink. If it is out of ink, replace it. See “Replacing Ink Tanks” on page 67.
- Ensure that all the orange tape of the ink tank has been peeled off.
- Press “PUSH” on the ink tank and ensure that the ink tank is installed securely.
- Ensure that each ink tank is installed at the correct location.

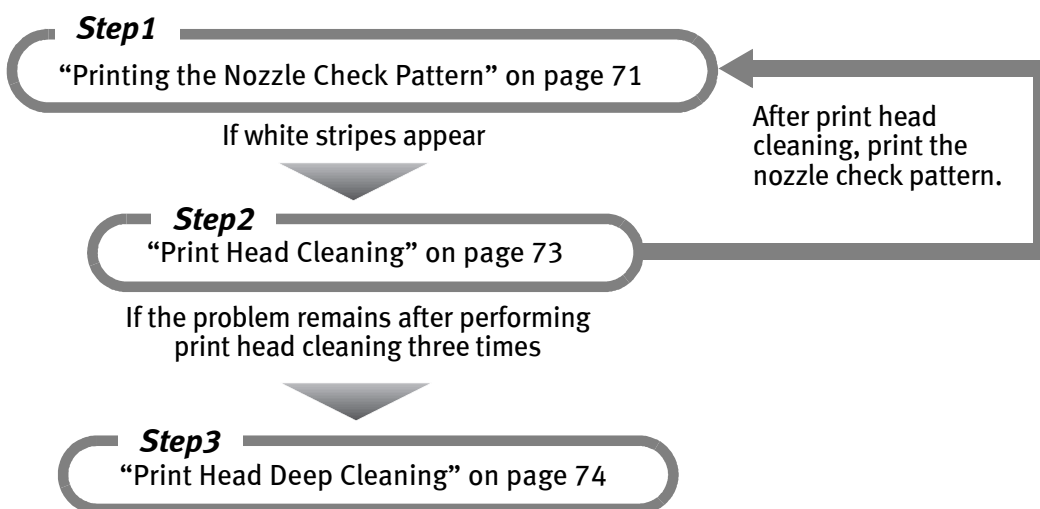

 **Note** If print head maintenance does not resolve the problem, contact the Customer Care Center.

If the ruled lines are shifted

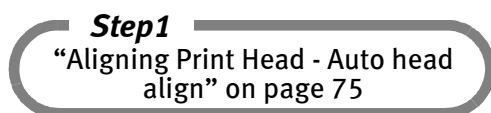

Printing the Nozzle Check Pattern

Print the nozzle check pattern to determine whether the ink ejects properly from the print head nozzles and to verify print head alignment. Use this function when printed results are blurred or the color is incorrect.

-  **Notes**
- Ensure that the inner cover is closed.
 - Nozzle check pattern printing can be performed also from the printer itself.
 - (1) With the printer on, load a sheet of Letter-sized plain paper in the sheet feeder or cassette.
 - (2) Press the paper feed switch to select the paper source in which you loaded the paper.
 - (3) Hold down the **RESUME** button until the **POWER** lamp flashes twice.

1 With the printer on, load a sheet of Letter-sized paper in the printer.

2 Printing the nozzle check pattern.

(1) Press the **Menu** button.



(2) Use the ◀ ▶ buttons to select **Tool Box** and then press the **OK** button.
The Tool Box screen is displayed.

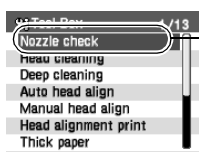

(3) Use the ▲ ▼ buttons to select **Nozzle check** and then press the **OK** button.
The pattern print confirmation screen is displayed.

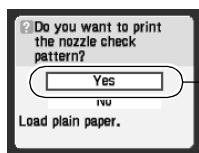

(4) Use the ▲ ▼ buttons to select **Yes** and then press the **OK** button.
The nozzle check pattern is printed.

(5) Examining the nozzle check pattern.

Examining the Nozzle Check Pattern

The nozzle check pattern should appear as follows when ink is discharged properly. Examine the nozzle check pattern output by the printer.



- (1) Examining the nozzle check pattern.

The Pattern Check screen appears on the LCD after printing the nozzle check pattern.

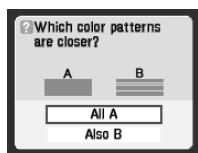

- (2) Use the ▲ ▼ buttons to select the pattern more similar to the printed pattern, then press the **OK** button.

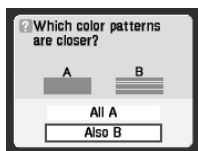

When all the patterns are printed normally, select **All A** and press the **OK** button.

The screen returns to the Tool Box screen.

When a white stripe exists on any of the printed patterns, select **Also B** and press the **OK** button. The Head Cleaning screen is displayed.

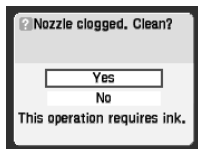

Select **Yes** and press the **OK** button to start Head Cleaning.

See "Print Head Cleaning" on page 73.

Print Head Cleaning

Clean the print head if you suspect that the nozzles might be clogged.
Cleaning the print head consumes ink, so perform print head cleaning only when necessary.

 **Note** Ensure that the inner cover is closed.

1 Ensure that the printer is on.

2 Print Head Cleaning.

(1) Press the **Menu** button.



(2) Use the ◀ ▶ buttons to select **Tool Box** and then press the **OK** button.
The Tool Box screen is displayed.

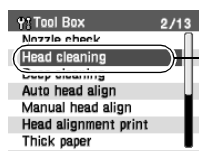

(3) Use the ▲ ▼ buttons to select **Head cleaning** and then press the **OK** button.
The confirmation screen is displayed.

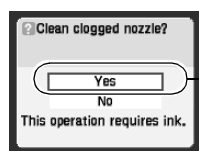

(4) Use the ▲ ▼ buttons to select **Yes** and then press the **OK** button.

Important Do not perform any other operations until the print head cleaning finishes. This takes about 30-40 seconds.

 **Note** **After print head cleaning finishes**

After print head cleaning finishes, print the nozzle check pattern to verify that the print head nozzles are clean. See “Printing the Nozzle Check Pattern” on page 71.

When ink is low, the nozzle check pattern is not printed correctly. See “Replacing Ink Tanks” on page 67.

If the print quality remains poor, repeat head cleaning 3 times.

If the print quality still remains poor, perform deep cleaning. See “Print Head Deep Cleaning” on page 74.

Print Head Deep Cleaning

If print quality does not improve by standard print head cleaning, try print head deep cleaning, which is a more powerful process. Print head deep cleaning consumes ink, so perform this procedure only when necessary.

 **Note** Ensure that the inner cover is closed.

1 Ensure that the printer is on.

2 Print Head Deep Cleaning.

(1) Press the **Menu** button.



(2) Use the ◀ ▶ buttons to select **Tool Box** and then press the **OK** button.
The Tool Box screen is displayed.

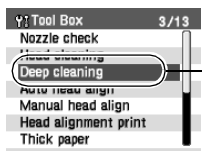

(3) Use the ▲ ▼ buttons to select **Deep cleaning** and then press the **OK** button.
The confirmation screen is displayed.

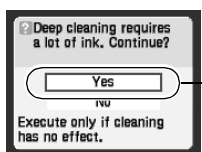

(4) Use the ▲ ▼ buttons to select **Yes** and then press the **OK** button.

Important The process takes about one minute to complete, so simply wait until the **POWER** lamp stops flashing.

 **Note** **After print head cleaning finishes**

After print head deep cleaning finishes, print the nozzle check pattern to verify that the print head nozzles are clean. See “Printing the Nozzle Check Pattern” on page 71.

When one specific color only does not print, see “Replacing Ink Tanks” on page 67.

If the problem remains, make sure that ink remains in the ink tank. Then turn off the printer's power for at least 24 hours, and perform deep cleaning of the print head again.

If the problem still remains, the print head may be damaged. Contact the Customer Care Center.

Aligning Print Head - Auto head align

Aligning the print head position allows you to print without shifts in the color registration. There are two ways to align the print head, automatic or manual. First, try adjusting the print head automatically. If the automatic print head aligning does not work or if you wish, you can adjust the print head manually. See “Adjusting the Print Head Manually” on page 78.

 **Note** Ensure that the inner cover is closed.

1 With the printer on, load a sheet of Letter-sized paper in the sheet feeder.

Caution The cassette does not feed paper for aligning the print head. Load paper in the sheet feeder.

2 Align the print head automatically.

(1) Press the **Menu** button.



(2) Use the ◀ ▶ buttons to select **Tool Box** and then press the **OK** button.
The Tool Box screen is displayed.

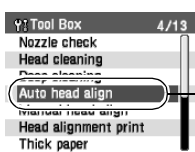

(3) Use the ▲ ▼ buttons to select **Auto head align** and then press the **OK** button.
The confirmation screen is displayed.

 **Note** You can print the current settings by selecting **Head alignment print**.

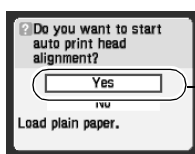

(4) Use the ▲ ▼ buttons to select **Yes** and then press the **OK** button.
A pattern is printed and the print head is automatically aligned.



Note When Automatic Print Head Aligning Cannot Be Executed Correctly

When automatic print head aligning cannot be executed correctly, the **POWER** lamp flashes orange 11 times and the message “Failed to align print head” is displayed on the LCD. Please follow the procedure below.

1. Press the **RESUME** button to clear the error.
2. Open the cover and check if there is ink left. If there is no ink left, replace the ink tanks. See “Replacing Ink Tanks” on page 67.
3. Print the nozzle check pattern to verify that the print nozzles are clean. See “Printing the Nozzle Check Pattern” on page 71.
4. Move the printer so that the paper output slot is not in direct sunlight and try automatic print head aligning again.
5. If the error persists, adjust the print head manually. See “Adjusting the Print Head Manually” on page 78.

Troubleshooting

Let's take a look at countermeasures against troubles which may occur during use of the printer.

 **Note** Here, we will discuss errors indicated on the LCD, problems that might occur during direct printing from the digital camera. If you cannot find the symptom corresponding to a certain problem, refer to the *User's Guide*.

- “A Message is Displayed on the LCD” on page 77
- “Cannot See the Display Properly on the LCD/Cannot See the Display on the LCD” on page 79
- “Ink Does Not Come Out/ Printing is Blurred/Colors are Wrong/White Streaks” on page 79
- “Printed Surface is Scratched” on page 80
- “Paper Jams” on page 81
- “Cannot Print Properly from the Digital Camera” on page 84

A Message is Displayed on the LCD

If a message is displayed on the LCD, take the corresponding countermeasure described below.

Message	Try This
No photos in memory card.	Photo data edited/processed on the computer should be printed from the computer, not from the camera.
Waste ink absorber* almost full.	Press the RESUME button to recover from the error. You can print photos for a while but you cannot print any more photo when the waste ink absorber becomes full. Contact the Customer Care Center.
Read-write mode enabled.	The memory card utility started on the computer has write-enabled the card slot. When the card slot is write-enabled, the printer cannot print photos. When you have finished writing data to the card, select the read-only mode. For the cancellation procedure, see “Setting up the Card Slot as the Memory Card Drive of the Computer” on page 64.
Failed to align print head. Press Resume and see manual.	Press the RESUME button and follow the procedure below. (1) Open the cover and check if there is ink left. If there is no ink left, replace the ink tanks. See “Replacing Ink Tanks” on page 67. (2) Print the nozzle check pattern to verify that the print nozzles are clean. See “Printing the Nozzle Check Pattern” on page 71. (3) Move the printer so that the paper output slot is not in direct sunlight and try automatic print head aligning again. (4) If the error persists, adjust the print head manually.
Cannot communicate with a connected device. Please remove it and press Resume.	Disconnect the camera connection cable, press the RESUME button, and then connect the cable once more. The digital camera should be turned on automatically. If not, turn it on manually.

Message	Try This
Unsupported device connected. Please remove and press Resume.	Disconnect the camera connection cable, press the RESUME button, and then connect the cable once more. If the error is still unresolved, there is a possibility that you are using a digital camera or digital video camcorder that is not supported by this printer. Connect only digital cameras or digital video camcorders that are compatible with this printer.
Cassette is selected. Switch to the sheet feeder.	When paper feeding is set to be done from the cassette, paper cannot be fed from the sheet feeder.
Error code	Turn off the printer, remove the power cord plug from the outlet and leave the printer for about 10 minutes. Then plug the power cord back in, and turn on the printer again. If the same error persists, contact the Customer Care Center.

* The waste ink absorber absorbs ink used during cleaning.

Note Adjusting the Print Head Manually

If the automatic print head adjustment does not work or if you wish to adjust the print heads manually, follow the procedure below.

1. With the printer on, load two sheets of Letter-sized plain paper in the sheet feeder.
2. Press the **Menu** button.
3. Use the ◀ ▶ buttons to select **Tool Box** and then press the **OK** button.
4. Use the ▲ ▼ buttons to select **Manual head align** and then press the **OK** button.

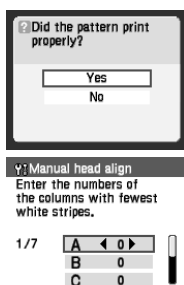



5. Use the ▲ ▼ buttons to select **Yes** and then press the **OK** button.
6. The message of "Did the pattern print properly?" is displayed on the LCD.
Use the ▲ ▼ buttons to select **Yes** and then press the **OK** button.
7. Examine the printed pattern and enter the number of column "A" with fewest white stripes using the ◀ ▶ buttons.
8. Press the **OK** button.
9. Use the ▼ button and move the cursor to column "B".
10. Repeat Steps (7) through (8) and enter the pattern numbers up to column "G".
11. After entering the pattern numbers up to column "G", press the **OK** button.

■ Cannot See the Display Properly on the LCD/Cannot See the Display on the LCD

Possible Cause	Try This
Cannot see the display properly on the LCD/the display on the LCD is illegible	Adjust the contrast of the LCD in the Contrast menu in the Tool Box . See “Adjusting Contrast of the LCD” on page 47.
Cannot see the display on the LCD	The LCD may be in the screen-saver mode. Press the OK button to turn on the LCD again. * If you leave the printer more than 5 minutes without using any button on the operation panel, the LCD goes into the screen-saver mode automatically.

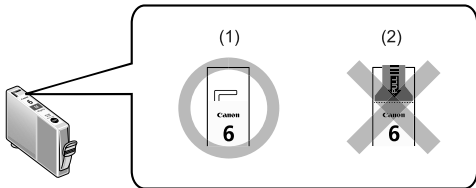
■ Ink Does Not Come Out/ Printing is Blurred/Colors are Wrong/White Streaks

Possible Cause	Try This
Ink tank is not seated properly/ Ink tank is empty	<p>Check that the ink tanks are firmly seated in the print head and reseal them if necessary.</p> <ul style="list-style-type: none"> Check to see if all the orange tape has been removed as shown in (1). If a part of the orange tape remains as shown in (2), remove it. <div data-bbox="467 751 944 939">  </div> <p>If ink tank is empty: See “Replacing an Ink Tank” on page 66.</p>
Incorrect paper type	On the operation panel, confirm that the Media Type selected matches the paper loaded.
Print head nozzles clogged or shifted	<p>Print the nozzle check pattern to check for uneven ink output. When a specific color is missing from the nozzle check pattern, clean the print head.</p> <ul style="list-style-type: none"> If ink supply is uneven: See “Print Head Cleaning” on page 73. If straight lines are shifted: See “Aligning Print Head - Auto head align” on page 75.
Media not loaded print-side up	<p>Check that your paper is loaded with the correct print side facing up.</p> <p> Note Follow the instructions packaged with your specialty media for loading and handling.</p>
The inner cover is open	<p>Close the inner cover and click the RESUME button on the printer. Ensure that the inner cover is completely closed, since if it is not, you cannot print because the paper will not feed properly.</p> <div data-bbox="440 1350 719 1567">  </div>

■ Printed Surface is Scratched

Possible Cause	Try This
Inappropriate Paper Type is used.	<ul style="list-style-type: none"> • Check to see if the paper you are printing on is too thick. See "Print Media to Avoid" on page 15. • If paper is curled, it may be smudged or may not feed properly. Make the paper flat. Refer to "Uncurling the Media" on the <i>User's Guide</i>. • Note that smudging may occur at the top and bottom edges of the paper when using Borderless Printing. Ensure that the paper you are using is compatible with Borderless Printing.



Note If the printed surface is still scratched:

Follow the procedure below and set the **Thick paper** to **Thick paper**. This procedure also applies to direct printing from your camera.

1. Press the **Menu** button.
2. Use the ◀ ▶ buttons to select **Tool Box** and then press the **OK** button.
3. Use the ▲ ▼ buttons to select **Thick paper** from the Tool Box screen and then press the **OK** button.

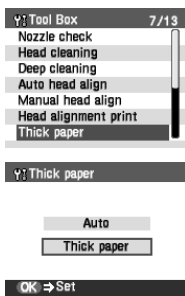

4. Use the ▲ ▼ buttons to select **Thick paper** and then press the **OK** button.

* After printing is completed, return the **Thick paper** to **Auto**.

■ Paper Jams

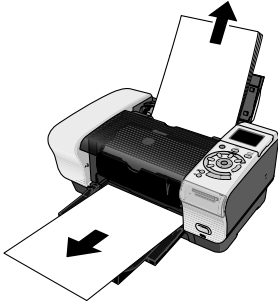
Message	Try This
Paper Jams in the Paper Output Slot	<p>Remove the paper according to the following procedure.</p> <p>(1) Slowly pull the paper out from the paper output slot.</p>  <ul style="list-style-type: none">• If the paper is jammed in the sheet feeder, slowly pull the paper out from the sheet feeder.• If you cannot pull the paper out, turn the printer off and turn it back on. The paper will be ejected automatically. <p>(2) If you cannot pull the paper out in step (1), or the paper tears and a piece remains inside the printer, open the cover and remove it. After removing all paper, close the cover.</p> <p>Be careful not to touch the components inside the printer.</p> <p>(3) Reload the paper into the printer and press the RESUME button on the printer.</p> <p>(4) If the error persists, adjust the print head manually.</p> <ul style="list-style-type: none">• If you have turned off the printer in step (1), you will need to retry printing, because this operation cancels any print jobs in progress.• If you cannot remove the paper or the paper tears inside the printer, or if the paper jam error continues after removing the paper, contact the Customer Care Center.

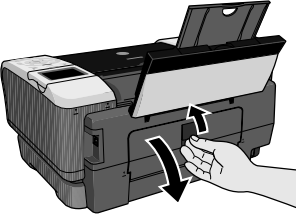
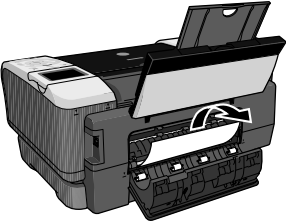
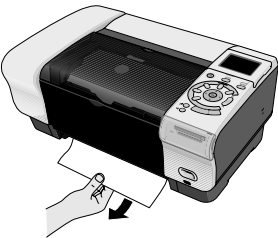
Message	Try This
<p>Paper jams inside the Transport Unit</p>	<p>Remove the paper according to the following procedure.</p> <p>(1) Open the rear cover.</p>  <p>(2) When you can see the jammed paper, slowly pull the paper out.</p>  <ul style="list-style-type: none"> • Be careful not to touch the components inside the printer. • If you cannot extract the paper, turn the printer off, and then turn it back on. The paper will be ejected automatically. <p>(3) Close the rear cover.</p> <p>(4) If you could not extract the paper in step (2), remove the cassette.</p> <p>(5) Slowly pull the jammed paper out.</p>  <p>(6) If any paper is sticking out of the cassette, reload the paper in the cassette.</p> <p>(7) Reload the paper in the sheet feeder if necessary, and press the RESUME button on the printer.</p> <ul style="list-style-type: none"> • If you have turned off the printer in step (2), you will need to retry printing, because this operation cancels any print jobs in progress. • If you cannot remove the paper or the paper tears inside the printer, or if the paper jam error continues after removing the paper, contact the Customer Care Center.

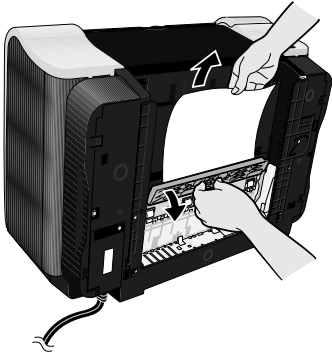
Message	Try This
<p>Paper Jams inside the Duplex Transport Section</p>	<p>Remove the paper according to the following procedure.</p> <ol style="list-style-type: none"> (1) Remove the cassette. If the paper is loaded in the sheet feeder, remove the paper from the sheet feeder. Warning Support the cover and the paper support with your hands when standing the printer. (2) Stand the printer with the rear side down. (3) Slowly pull the jammed paper out while pulling the green cover toward you.  <p>Warning Put back the printer immediately after removing the jammed paper.</p> <ol style="list-style-type: none"> (4) If any paper is sticking out of the cassette, reload the paper in the cassette. Reload paper in the sheet feeder, if necessary. (5) Insert the cassette into the printer. (6) Press the RESUME button on the printer. <ul style="list-style-type: none"> • If you cannot remove the paper or the paper tears inside the printer, or if the paper jam error continues after removing the paper, contact the Customer Care Center.

■ Cannot Print Properly from the Digital Camera

The following are the possible errors that may occur when printing directly from a digital still camera or digital video camcorder*, and the countermeasures to eliminate them.

*Hereafter, the digital still camera and digital video camcorder are collectively called a digital camera or camera.

Error message on camera	Try This
Printer in use	Photos are printed from the computer. Wait until printing ends. The printer automatically starts printing the photos from the camera after completing the current printing.
Printer warming up	Wait until warm-up ends. When it is ready, the printer starts printing automatically.
No paper	Load paper in either the sheet feeder or cassette which you have selected with the paper feed switch on the printer, and select Continue ^{*1} in the display on your camera.
Paper error	The paper output tray is closed. Open it to resume printing. If the inner cover is open, close it.
Paper jam	Select Stop in the display on your camera to stop printing. Remove the jammed paper, load new paper, and press the RESUME button on the printer to resume printing.
Printer cover open	Close the cover on the printer.
No print head	The POWER lamp on the printer flashes five times. No print head is installed. Install a print head according to the <i>Quick Start Guide</i> . When there is a print head installed, the print head is defective. Contact the Customer Care Center.
Waste tank (ink absorber ^{*2}) full	The waste ink absorber ^{*2} is nearly full. The printer has a built-in waste ink absorber to hold the ink used during print head cleaning. This error message indicates that the waste ink absorber is nearly full. You can continue printing for a while by selecting Continue ^{*1} in the display on your camera. However, because printing is disabled once the waste ink absorber becomes completely full, you are recommended to contact the Customer Care Center as early as possible.
Ink is low	It is about time to replace the ink tank with a new one. Select Continue ^{*1} in the display on your camera to resume the printing.
Ink tank is empty	Printing resumes once the cover is closed after ink tank replacement. You can continue printing by selecting Continue ^{*1} in the display on your camera with the ink tank empty. But, it is recommended you replace it with a new one immediately after printing. It may damage the printer if you continue printing with empty ink tanks.
Printer error	Select Stop in the display on your camera to stop printing. Disconnect the cable between the printer and the camera, turn off the printer, and unplug the power cord of the printer from the power supply. After a while, plug the power cord of the printer back in, turn on the printer, and then reconnect the camera to the printer. If the same error occurs, contact the Customer Care Center.

*¹To resume printing, you can press the **RESUME** button on the printer instead of selecting **Continue**.

*²The waste ink absorber absorbs ink used for cleaning.



Notes

- PictBridge or Canon Bubble Jet Direct compatible digital cameras can be connected to your printer for direct printing.
- This section describes errors that are indicated on Canon-brand PictBridge- or Bubble Jet Direct-compatible cameras. The error messages and operations may vary depending on the camera you are using.
For errors on non-Canon PictBridge-compatible cameras, count the number of flashes the **POWER** lamp on the printer makes and check for the cause of the error and take the appropriate action. For details, refer to “**Handling Error Messages**” in the *User's guide*.
- Connecting a digital camera not compatible with PictBridge or Bubble Jet Direct makes the **POWER** lamp on your printer flash nine times. In such a case, unplug the cable connecting the camera to the printer, and press the **RESUME** button on the printer.
- A communication time out occurs if printing takes a long time or if it takes too much time to send data. This may stop printing. In such a case, disconnect the cable between the printer and the camera, press the **RESUME** button on the printer, and reconnect the cable between the printer and the camera. Then, turn the camera on, if it does not automatically turn on. If the problem is still unresolved, select some other photo and check if it can be printed or not.
- The print head nozzles may be clogged if printing becomes faint or colors are incorrect. See “**When Printing Becomes Faint or Colors are Incorrect**” on page 70.
- If the paper is curled or its surface is scratched during printing, make sure that you are using the correct type of paper. If this error occurs even when you are using the correct type of paper, select **Thick paper** in the **Thick paper** menu. See “**If the printed surface is still scratched:**” on page 80.
- To disconnect the cable connected between the digital camera and printer, follow the procedure below.
 1. Disconnect the cable from the printer.
 2. Turn off the digital camera.
 3. Disconnect the cable from the digital camera.When disconnecting the cable, be sure to hold the connector by its sides.
- For the errors indicated on the camera and their solution, also refer to the user's manual of the camera. For other troubles on the digital camera, contact the manufacturer.

Index

A

Adjusting the Print Head Manually	78
Aligning Print Head	75
Auto head align	7, 75

B

Back Button	3
Basic (Print Settings)	28
BCI-6BK	66
BCI-6C	66
BCI-6M	66
BCI-6PC	66
BCI-6PM	66
BCI-6Y	66
brightness	29
Bubble Jet Direct	52

C

Cancel Button	4
Card Eject Button	5, 13
Card Slot	5, 64
Card Slot Cover	5
cassette	15, 19
Cassette Lamp	22
Color adjust (Print Settings)	29
Color balance	6, 40
color hue	29
Colors are Wrong	79
CompactFlash (CF) Card	10, 11, 13
Contrast (LCD)	6, 47
contrast (Print Settings)	29

D

Date display format	6, 49
Date print (PictBridge)	56
Deep cleaning	6, 74
digital camera	52
digital camera (Troubleshooting)	84
digital video camcorder	52
Direct Print Port	5
Direct Printing (Bubble Jet Direct)	57
Direct Printing (PictBridge)	54
DPOF	45
DPOF print	6, 45

E

Easy-PhotoPrint Startup Button	4, 62
Effects (Print Settings)	29

Empty ink tank	66
----------------------	----

F

Face brightener	29
-----------------------	----

H

Head alignment print	7
Head cleaning	6, 73

I

Image optimize	56
Indicator Lamp	5, 11, 13
Infrared Communication	58, 60
Infrared print	7, 58
Ink Does Not Come Out	79
Ink Tank	66
IrDA Interface Port	5, 60

L

Languages	7, 51
Layout (Infrared print)	58
Layout (PictBridge)	55
Layout print	5, 34
LCD	79
Load Limit Mark	18
Loading the Print Media (cassette)	19
Loading the Print Media (sheet feeder)	17
Low Ink	67

M

Maintenance	70
Manual head align	7, 78
Media Types (Bubble Jet Direct)	57
Media Types (card direct printing)	21
Media Types (Infrared print)	58
Media Types (PictBridge)	55
Memory Card	10, 11, 13
Memory Card (Browsing its photos on the computer) ...	62
Memory Card (Saving its data onto the computer)	63
Memory Card Utility	64
Memory Stick	10, 12, 14
Menu Button	3
Menu Displays	5
Microdrive	10, 11
Mobile Phone	58
MultiMedia Card	10, 12, 14

N

Noise reduction	29
-----------------------	----

Index

Nozzle check	6, 71
Nozzle Check Pattern (Examining)	72
Nozzle Check Pattern (Printing)	71
NR	56

O

OK Button	3
Operation Panel	3
Optimizer (Print Settings)	29

P

Paper Feed Switch	4, 22
Paper Jams	81
Photo Gallery	5, 22
Photo Optimizer PRO	29
Photo Print	5, 25
PictBridge	52
POP	29
POWER Button	3
POWER Lamp	3
Print all	6, 43
Print Button	4
Print index	6, 44
Print Media to Avoid	15
Print Setting Items	28
Print Settings	27
Print Studio	5
Printbeam	58
Printed Surface is Scratched	80
Printing is Blurred	79

Q

Quiet mode	6, 48
------------------	-------

R

Read/write attribute setting	64
Read/write mode	64
Read-only mode	64
Reset	7, 50
RESUME Button	3

S

Save Button	4, 63
SD card	12, 14
Search Button	3, 30
Searching for Photos	30
Secure Digital (SD) Card	10
Sepia	29
Settings Button	3, 27
sheet feeder	15
Sheet Feeder Lamp	22
Simulate illustration	29

SmartMedia Card	10
SmartMedia card	12, 13
Sticker print	6, 37

T

Thick paper	7, 80
Tool Box	6
Trimming	32
Trimming Button	4, 32
Trimming Guide	32

U

USB Memory Card Settings	64
--------------------------------	----

V

VIVID	56
Vivid Photo	29
VIVID+NR	56

W

Waste ink absorber	77, 78
White Streaks	79

Z

zoom	23
------------	----