

# PowerShot A620/A610 SYSTEM MAP

DIGITAL CAMERA

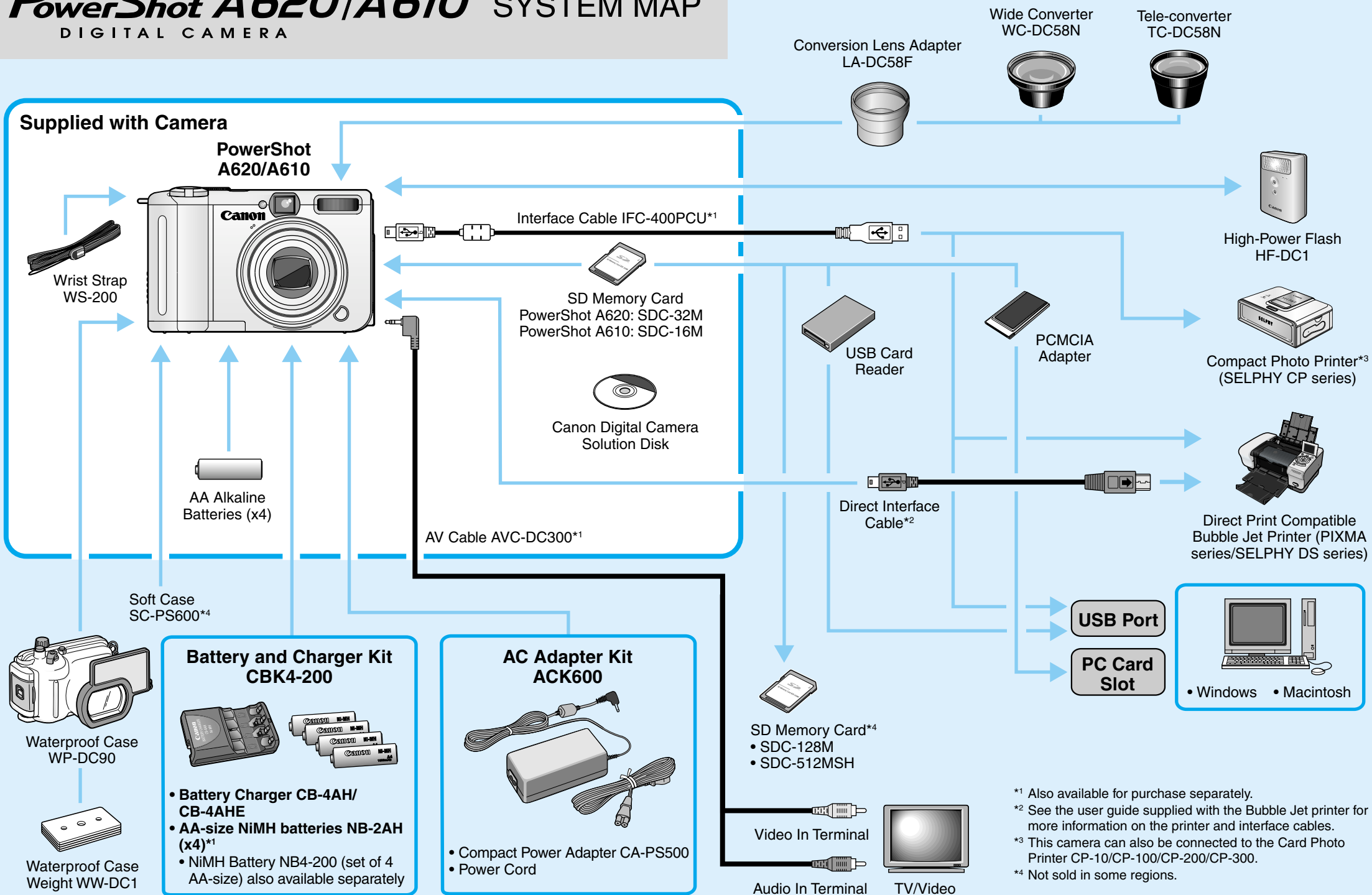

\*1 Also available for purchase separately.

\*2 See the user guide supplied with the Bubble Jet printer for more information on the printer and interface cables.

\*3 This camera can also be connected to the Card Photo Printer CP-10/CP-100/CP-200/CP-300.

\*4 Not sold in some regions.

## Confirming the Package Contents

Your camera package includes all of the following items. If any of these items are missing, please contact the dealer for assistance.

- Digital Camera
- Wrist Strap WS-200
- AA Alkaline Batteries (x4)
- SD Memory Card  
PowerShot A620: SDC-32M  
PowerShot A610: SDC-16M
- Interface Cable IFC-400PCU
- AV Cable AVC-DC300
- Canon Digital Camera Solution Disk
- Basic Camera User Guide
- Advanced Camera User Guide
- Direct Print User Guide
- Software Starter Guide
- System Map (this sheet)
- Warranty Card
- “For Windows® XP and Mac OS X Users” Leaflet
- “Canon Customer Support” Leaflet

## Optional Accessories

The following camera accessories are sold separately. **Some accessories are not sold in some regions.**

### Lenses, Lens Adapter

#### ● **Conversion Lens Adapter LA-DC58F**

This adapter is required for mounting the wide converter and tele-converter to the camera.

#### ● **Wide Converter WC-DC58N**

Converts the focal distance of the body lens by a factor of approximately 0.7 (35mm film equivalent at maximum wide angle: approximately 25 mm) when attached.

#### ● **Tele-converter TC-DC58N**

Converts the focal distance of the body lens by a factor of approximately 1.75 (35mm film equivalent at maximum telephoto: approximately 245 mm) when attached.

### Flash5

#### ● **High-Power Flash HF-DC1**

This attachable supplementary flash can be used to capture the photographic subjects that are too distant for the built-in flash to illuminate.

### Power Supplies

#### ● **AC Adapter Kit ACK600**

This kit lets you power the camera from any standard household power outlet. Recommended to power a camera for an extended period of time or when connecting to a computer.

#### ● **Battery and Charger Kit CBK4-200**

This dedicated battery charger kit includes both a charger unit and four rechargeable AA-size NiMH (nickel metal hydride) batteries. Convenient when taking or playing back large numbers of images.

#### ● **NiMH Battery NB4-200**

A set of four rechargeable AA-size NiMH batteries.

### Connection Accessory

This connection accessory can be used with computers equipped with genuine built-in USB interfaces and running the following operating systems.

**Windows:** Systems running preinstalled Windows 98 Second Edition (SE), Windows Me, Windows 2000 Service Pack 4, or Windows XP (including Service Pack 1 and Service Pack 2)

**Macintosh:** Mac OS X (v10.2 – v10.3)

#### ● **Interface Cable IFC-400PCU**

Use this cable to connect the camera to a computer, Compact Photo Printer (SELPHY series) or to a Bubble Jet printer (refer to your Bubble Jet printer user guide).

### Other Accessories

#### ● **SD Memory Card**

SD memory cards are used to store images recorded by the camera. Canon brand cards are available in 128 MB and 512 MB capacities.

#### ● **AV Cable AVC-DC300**

Use this cable to connect the camera to a TV set.

#### ● **Waterproof Case WP-DC90**

You can use this case to take underwater shots at depths of up to 40 meters (130 feet), and of course it's ideal for taking worry-free pictures in the rain, at the beach, or on the ski slopes.

#### ● **Soft Case SC-PS600**

Protects the camera from dust and scratches.

## Direct Print Compatible Printers

Canon offers the following separately sold printers for use with the camera. You can produce photo quality prints quickly and easily by connecting them to the camera with a single cable and operating the camera's controls.

#### ● **Compact Photo Printers (SELPHY series)**

#### ● **Bubble Jet Printers**

For more information, visit your nearest Canon retailer.